

# LIMITED SITE INVESTIGATION

Auto Salvage Yard – Fontana

15719 – 15765 Arrow Boulevard

Fontana, San Bernardino County, CA 92335

December 3, 2020

Terracon Project No. CB207103A



**Prepared for:**

WPT Acquisitions, LLC  
Minneapolis, Minnesota

**Prepared by:**

Terracon Consultants, Inc.  
Colton, California

[terracon.com](http://terracon.com)

**Terracon**

Environmental   ●   Facilities   ●   Geotechnical   ●   Materials

December 3, 2020

WPT Acquisitions, LLC  
150 South Fifth Street  
Suite 2675  
Minneapolis, Minnesota 55422

Attn: Spencer Gerberding  
P: (612) 800-8505  
E: [sgerberding@wptreit.com](mailto:sgerberding@wptreit.com)

Re: Limited Site Investigation  
Auto Salvage Yard – Fontana  
15719 – 15765 Arrow Boulevard  
Fontana, San Bernardino County, California 92335  
Terracon Project No. CB207103A

Dear Mr. Gerberding:

Terracon Consultants, Inc. (Terracon) is pleased to submit the enclosed Limited Site Investigation report for the above referenced site. This assessment was performed in general accordance with Terracon's Supplement to Agreement for Services (Reference Number: PCB207103A), executed October 5, 2020.

We appreciate the opportunity to perform these services for WPT Acquisitions, LLC. Please contact the undersigned at (909) 824-7311 if you have questions regarding the information provided in the report.

Sincerely,  
**Terracon Consultants, Inc.**

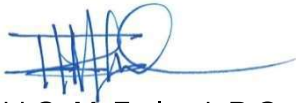

Todd G. McFarland, P.G., C.H.G.  
Environmental Department Manager



Carl A. Parten  
Senior Principal / Office Manager III

Attachments

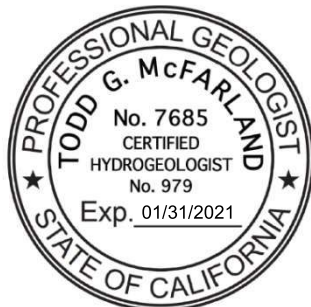

## TABLE OF CONTENTS

<b>1.0</b>	<b>INTRODUCTION</b> .....	<b>1</b>
1.1	Site Description .....	1
1.2	Scope of Work .....	1
1.3	Standard of Care .....	2
1.4	Additional Scope Limitations .....	2
1.5	Reliance .....	2
<b>2.0</b>	<b>FIELD ACTIVITIES</b> .....	<b>2</b>
2.1	Pre-Mobilization .....	3
2.2	Soil Borings and Soil Sampling .....	3
<b>3.0</b>	<b>LABORATORY ANALYTICAL METHODS</b> .....	<b>4</b>
3.1	Soil .....	4
<b>4.0</b>	<b>DATA EVALUATION</b> .....	<b>4</b>
4.1	Soil Analytical Results – TPH and VOCs .....	4
4.2	Soil Analytical Results – Metals .....	6
<b>5.0</b>	<b>FINDINGS AND CONCLUSIONS</b> .....	<b>6</b>
<b>6.0</b>	<b>RECOMMENDATIONS</b> .....	<b>7</b>

## APPENDICES

### APPENDIX A – EXHIBITS

Exhibit 1 – Topographic Map

Exhibit 2 – Site Diagram

### APPENDIX B – BORING LOGS

### APPENDIX C – ANALYTICAL REPORTS AND CHAIN-OF-CUSTODY

**LIMITED SITE INVESTIGATION  
 AUTO SALVAGE YARD – FONTANA  
 15719 – 15765 ARROW BOULEVARD  
 FONTANA, SAN BERNARDINO COUNTY, CALIFORNIA 92335  
 Terracon Project No. CB207103A  
 December 3, 2020**

## 1.0 INTRODUCTION

### 1.1 Site Description

<b>Site Name</b>	Auto Salvage Yard – Fontana
<b>Site Location/Address</b>	15719 - 15765 Arrow Boulevard, Fontana, California 92335
<b>General Site Description</b>	The site is improved with a pallet yard at 15719 Arrow Boulevard, Riteway Auto Dismantlers at 15765 Arrow Boulevard, and All Auto Parts at 15755 Arrow Boulevard.

A topographic map and site diagram are included as Exhibits 1 and 2 of Appendix A, respectively.

### 1.2 Scope of Work

Terracon conducted a Limited Site Investigation (LSI) at the site, located at 15719 - 15765 Arrow Boulevard, Fontana, California 92335 (the site). The scope of work conducted with your approval, was performed in response to Terracon’s Phase I Environmental Site Assessment for the site (Terracon’s ESA – Report No. CB207103, Draft dated October 23, 2020). Terracon’s Phase I ESA identified the following Recognized Environmental Conditions (RECs):

<b>REC/Site Concern</b>	<b>Description</b>
<i>On-site auto dismantling/salvage facilities</i>	<i>The historical and continued on-site operations as a dismantling / salvage facilities (approximately 40 to 60 years), and significant ground staining represents a REC in connection with the site.</i>
<i>Inaccessible areas of the site</i>	<i>The visually obstructed and inaccessible areas of the on-site pallet business and the automotive storage yards, represent a REC to the site.</i>

The objective of the LSI was to evaluate the presence of petroleum hydrocarbons, volatile organic compounds (VOCs), and metals commonly associated with the identified RECs at concentrations above laboratory reporting limits in on-site soil. Groundwater in the vicinity of the site was estimated to be at an approximate depth of 75 feet below ground surface (bgs) based on data from a nearby facility; therefore, an evaluation of groundwater was not included in the proposed scope.

## Limited Site Investigation

Auto Salvage Yard – Fontana ■ Fontana, CA  
December 3, 2020 ■ Terracon Project No. CB207103A



### 1.3 Standard of Care

Terracon's services were performed in a manner consistent with generally accepted practices of the profession undertaken in similar studies in the same geographical area during the same time period. Terracon makes no warranties, either express or implied, regarding the findings, conclusions, or recommendations. Please note that Terracon does not warrant the work of laboratories, regulatory agencies, or other third parties supplying information used in the preparation of the report. These LSI services were performed in accordance with the scope of work agreed with you, our client, as reflected in our proposal and were not restricted by ASTM E1903-97.

### 1.4 Additional Scope Limitations

Findings, conclusions, and recommendations resulting from these services are based upon information derived from the on-site activities and other services performed under this scope of work; such information is subject to change over time. Certain indicators of the presence of hazardous substances, petroleum products, or other constituents may have been latent, inaccessible, unobservable, nondetectable, or not present during these services, and we cannot represent that the site contains no hazardous substances, toxic materials, petroleum products, or other latent conditions beyond those identified during this LSI. Subsurface conditions may vary from those encountered at specific borings or wells or during other surveys, tests, assessments, investigations, or exploratory services; the data, interpretations, findings, and our recommendations are based solely upon data obtained at the time and within the scope of these services.

### 1.5 Reliance

This report has been prepared for the exclusive use of and reliance of WPT Acquisitions, LLC. Use or reliance by any other parties (except a governmental entity having jurisdiction over the site) is prohibited without the express written authorization of and reliance of WPT Acquisitions, LLC and Terracon. Any unauthorized distribution or reuse is at and reliance of WPT Acquisitions, LLC sole risk. Notwithstanding the foregoing, reliance by authorized parties will be subject to the terms, conditions, and limitations stated in the proposal, LSI report, and Terracon's Terms and Conditions. The limitation of liability defined in the terms and conditions is the aggregate limit of Terracon's liability to and reliance of WPT Acquisitions, LLC unless otherwise agreed in writing.

## 2.0 FIELD ACTIVITIES

Terracon's field activities were conducted from October 2 through October 7, 2020, by a staff geologist under the oversight of a California-licensed Professional Geologist (P.G.) with Terracon. A site-specific health and safety plan was utilized by Terracon during field activities for all phases of this assessment.

## Limited Site Investigation

Auto Salvage Yard – Fontana ■ Fontana, CA  
December 3, 2020 ■ Terracon Project No. CB207103A



### 2.1 Pre-Mobilization

On October 2, 2020, and more than 48 hours prior to drilling activities, Terracon marked the boring locations and contacted DigAlert (Ticket No: B202760521) for clearance of public underground utilities in accordance with California law. On October 7, 2020, Pacific Coast Locators (PCL) conducted a geophysical survey of each proposal boring location to identify and clear underground utilities.

### 2.2 Soil Borings and Soil Sampling

On October 7, 2020, BC2 Environmental advanced 11 soil borings (B-1 through B-11) using a track-mounted limited access direct push drill rig to a maximum depth of 10 feet below ground surface (bgs). Drill rig refusal conditions were encountered within the gravel bearing silty sand at depths of 5 or 10 feet bgs. The approximate boring locations are shown on Exhibit 2 of Appendix A and are summarized below.

**Table 2.2 – Soil Boring Summary**

Location ID	Total Depth (feet bgs)	Soil Sample Depth(s) (feet bgs)	Sample Type	Assessment Area/REC
B-1	8	5, 8	Grab	Riteway Auto, auto dismantling area.
B-2	10	5, 10	Grab	Riteway Auto, auto dismantling area and sump.
B-3	5	5	Grab	Riteway Auto, auto dismantling area and sump.
B-4	5	5	Grab	All Auto, auto dismantling area and trench drain.
B-5	5	5	Grab	All Auto, wash down area.
B-6	5	3, 5	Grab	All Auto, auto dismantling area and sump.
B-7	5	5	Grab	All Auto, auto dismantling area and drum storage.
B-8	5	5	Grab	All Auto, auto dismantling area and drum storage.
B-9	5	5	Grab	All Auto, historical surface staining.
B-10	5	5	Grab	Former Arrow Salvage, historical surface staining.
B-11	5	5	Grab	Former Arrow Salvage, historical surface staining.

\*Sample depths selected for analytical testing.

Terracon collected continuous core soil samples from the soil borings to document soil lithology, color, moisture content, and staining, if present. The soils encountered consisted of silty sand and silty sand with gravel from surface or subgrade to the maximum depth of exploration, 10 feet bgs. Detailed lithologic descriptions are presented on the soil boring logs included in Appendix B.

Terracon screened the soil samples in the field using a calibrated MiniRae 3000 photoionization detector (PID) with a 10.6eV lamp to indicate the presence of total organic vapors (TOV). No staining were observed in the soil samples collected from each soil boring. The maximum PID

## Limited Site Investigation

Auto Salvage Yard – Fontana ■ Fontana, CA  
December 3, 2020 ■ Terracon Project No. CB207103A



reading of 33.9 parts per million by volume (ppmv) was detected at 3 feet bgs in B-6. The PID readings are recorded on the soil boring logs included in Appendix B.

Terracon's soil sampling program included the analysis of one soil sample from each boring. Terracon collected relatively undisturbed soil samples from new acetate sleeves driven by the direct-push rig. Samples were also collected in laboratory provided containers. The field crew used new nitrile gloves for each sample collection to prevent cross contamination. The samples were labeled, sealed, recorded on chain-of-custody forms and stored in a chilled ice chest pending delivery to the laboratory. Based on the field PID readings, one additional sample was selected for analysis, B-6 at 3 feet bgs. Soil sample intervals for each boring are provided on the lithologic boring logs included in Appendix B.

Reusable drilling and sampling equipment was cleaned using an Alconox® or similar wash and two potable water rinses prior to the beginning of the project and before collecting each soil sample. Investigation derived waste (IDW) was not generated during this investigation.

## 3.0 LABORATORY ANALYTICAL METHODS

### 3.1 Soil

A total of 12 soil samples were selected for laboratory analysis. The soil samples and completed chain-of-custody forms were relinquished to SunStar Laboratories Inc., in Lake Forest, California, a State-of-California certified laboratory for analysis on a 48-hour rush turnaround time. The selected soil samples were analyzed using standard Environmental Protection Agency (EPA) methods and included:

- total petroleum hydrocarbons (TPH), carbon chain by EPA Method 8015B;
- volatile organic compounds (VOCs) by EPA Method 8260B; and
- California Administrative Manual (CAM) 17 metals by EPA Method 6010B7471.

## 4.0 DATA EVALUATION

Terracon screened the analytical data using the current residential and commercial Environmental Screening Levels (ESLs) published by San Francisco Bay Regional Water Quality Control Board (2019, Rev. 2). The detection of an analyte at a concentration above a screening level does not necessarily indicate an adverse impact to human health or the environment; however, an exceedance of a screening level may indicate that additional investigation is warranted.

### 4.1 Soil Analytical Results – TPH and VOCs

The soil analytical results for TPH and VOCs were below the specified laboratory report limit except for the samples collected from B-6, located adjacent to the sump of the auto dismantling



## Limited Site Investigation

Auto Salvage Yard – Fontana ■ Fontana, CA  
December 3, 2020 ■ Terracon Project No. CB207103A



area for All Auto. TPH as motor oil range organics (TPH-MORO), TPH as diesel range organics (TPH-DRO), ethylbenzene and xylenes were detected in boring B-6 at a depth of 3 feet bgs, and TPH-DRO was detected in boring B-6 at a depth of 5 feet bgs. Terracon compared the analytical results to the ESLs for residential and commercial land uses. The laboratory reported detections were below the applicable screening levels, and the results from the deeper sample indicated reduced or non-detectable concentrations. The soil analytical results are summarized in the following table and the laboratory analytical report and chain-of-custody forms are included in Appendix C.

**Table 4.1 - Soil Sample Analytical Results**

Sample ID	Boring ID	Sample Date	Sample Depth (feet bgs)	Ethylbenzene	Total xylenes	Other VOCs	TPH-GRO	TPH-DRO	TPH-MORO	
				EPA Method 8260B (mg/kg)			EPA Method 8015B (mg/kg)			
SB-1-8	B-1	10/7/2020	8	<0.0025	<0.0075	ND*	<10	<10	<10	
SB-2-10	B-2	10/7/2020	10	<0.0025	<0.0075	ND*	<10	<10	<10	
SB-3-5	B-3	10/7/2020	5	<0.0025	<0.0075	ND*	<10	<10	<10	
SB-4-5	B-4	10/7/2020	5	<0.0025	<0.0075	ND*	<10	<10	<10	
SB-5-5	B-5	10/7/2020	5	<0.0025	<0.0075	ND*	<10	<10	<10	
SB-6-3	B-6	10/7/2020	3	<b>0.0034</b>	<b>0.0327</b>	ND*	<10	<b>12</b>	<b>63</b>	
SB-6-5	B-6	10/7/2020	5	<0.0025	<0.0075	ND*	<10	<b>11</b>	<10	
SB-7-5	B-7	10/7/2020	5	<0.0025	<0.0075	ND*	<10	<10	<10	
SB-8-5	B-8	10/7/2020	5	<0.0025	<0.0075	ND*	<10	<10	<10	
SB-9-5	B-9	10/7/2020	5	<0.0025	<0.0075	ND*	<10	<10	<10	
SB-10-5	B-10	10/7/2020	5	<0.0025	<0.0075	ND*	<10	<10	<10	
SB-11-5	B-11	10/7/2020	5	<0.0025	<0.0075	ND*	<10	<10	<10	
<b>Screening Levels</b>										
				<i>Residential ESLs</i>	<i>5.9</i>	<i>580</i>	<i>--</i>	<i>430</i>	<i>260</i>	<i>12,000</i>
				<i>Commercial ESLs</i>	<i>3,400</i>	<i>2,500</i>	<i>--</i>	<i>2,000</i>	<i>1,200</i>	<i>180,000</i>

**Notes:**

All units are in milligrams per kilograms (mg/kg)

bgs= below ground surface

EPA = United States Environmental Protection Agency

TPH GRO = total petroleum hydrocarbons in gasoline carbon range (C6-C12);

TPH DRO = total petroleum hydrocarbons in diesel carbon range (C13-C28);

TPH MORO = total petroleum hydrocarbons in waste oil carbon range (C29-C40);

VOCs = Volatile Organic Compounds

ND\* = not detected above laboratory reporting limits. Multiple analytes, see laboratory report for specific reporting limits.

-- = multiple constituents for VOC analysis. Screening values omitted due to the ND laboratory results

"<" = less than the laboratory reporting limit specified

ESLs = San Francisco Bay Regional Water Quality Control Board Environmental Screening Levels (2019, Rev.2), Summary of Soil ESLs, Direct Exposure Human Health Risk Levels, Commercial/Industrial Shallow Soil Exposure, Table S-1.



## Limited Site Investigation

Auto Salvage Yard – Fontana ■ Fontana, CA  
December 3, 2020 ■ Terracon Project No. CB207103A



### 4.2 Soil Analytical Results – Metals

The soil analytical results for metals indicate non-detectable concentrations above the respective laboratory RLs with the exception of barium, chromium, cobalt, copper, nickel, vanadium, and zinc. The detectable metal concentrations were below the screening levels and within typical background concentrations. The soil analytical results are summarized in the following table and the laboratory analytical reports and chain-of-custody forms are included in Appendix C.

**Table 4.2 - Soil Sample Analytical Results – CAM 17 Metals**

Boring ID	Sample ID	Sample Date	Sample Depth (feet bgs)	Ba	Co	Cr	Cu	Ni	V	Zn	Other metals
B-2	SB-2-10	10/7/2020	10	35	3.6	10	8.6	5.9	20	23	ND
B-6	SB-6-3	10/7/2020	3	27	4.2	7.7	4.9	5.1	16	23	ND
Screening Levels											
Residential ESLs				15,000	23	NE	3,100	820	390	23,000	13
Commercial ESLs				220,000	350	NE	47,000	11,000	5,800	350,000	190

**Notes:**

All units are in milligrams per kilograms (mg/kg)

bgs= below ground surface

Ba = Barium; Co = Cobalt; Cr = Chromium; Cu = Copper; Ni = Nickel; V = Vanadium; Zn = Zinc

EPA = United States Environmental Protection Agency

NE = not established

< = less than the laboratory reporting limit specified

ESLs = Environmental Screening Levels (ESLs), Summary of Soil ESLs: Direct Exposure Human Health Risk Levels (Table S-1), San Francisco Bay Regional Water Quality Control Board, January 2019 (Rev. 2)

## 5.0 FINDINGS AND CONCLUSIONS

The findings of this LSI are as follows:

- Field observations and PID readings (maximum of 33.9 ppmv, B-6 at 3 feet bgs) indicated no significant impacts to the soils.
- Soil analytical results from soil samples collected from boring B-6, in the vicinity of All Auto - auto dismantling area and sump, indicated TPH-MORO and TPH-DRO concentrations of **63** and **12 mg/kg**, respectively, and ethylbenzene and total xylenes of **0.0034** and **0.0327 mg/kg**, respectively, which are below the applicable residential and commercial ESLs.
- Soil analytical results indicated concentrations of barium, chromium, cobalt, copper, nickel, vanadium, and zinc that were within typical background concentrations and below applicable residential and commercial ESLs. All remaining CAM 17 metals were not detected above the laboratory RLs.
- IDW was not generated for this investigation.

## Limited Site Investigation

Auto Salvage Yard – Fontana ■ Fontana, CA  
December 3, 2020 ■ Terracon Project No. CB207103A



- Groundwater was not encountered to the total depth of 10 feet bgs. Groundwater in the vicinity of the site was estimated to be at an approximate depth of 75 feet bgs.

Based on the field observations and laboratory data, historical and/or current automotive dismantling operations on the site have impacted surfaces and shallow soils; however, evidence of significant impairment were not identified in the areas accessible and investigated, and at the time the investigation was conducted. Concentrations of detected analytes were all below applicable residential and commercial screening levels.

## 6.0 RECOMMENDATIONS

Based on the results of this LSI, Terracon recommends that if onsite soils are to be disturbed during future excavations or construction activities, proper procedures should be followed with respect to worker health and safety, and any soil identified for disposal or export should be properly characterized, treated, and/or disposed in accordance with applicable local, state or federal regulations.

**APPENDIX A**  
**EXHIBIT 1 – TOPOGRAPHIC MAP**  
**EXHIBIT 2 – SITE DIAGRAM**

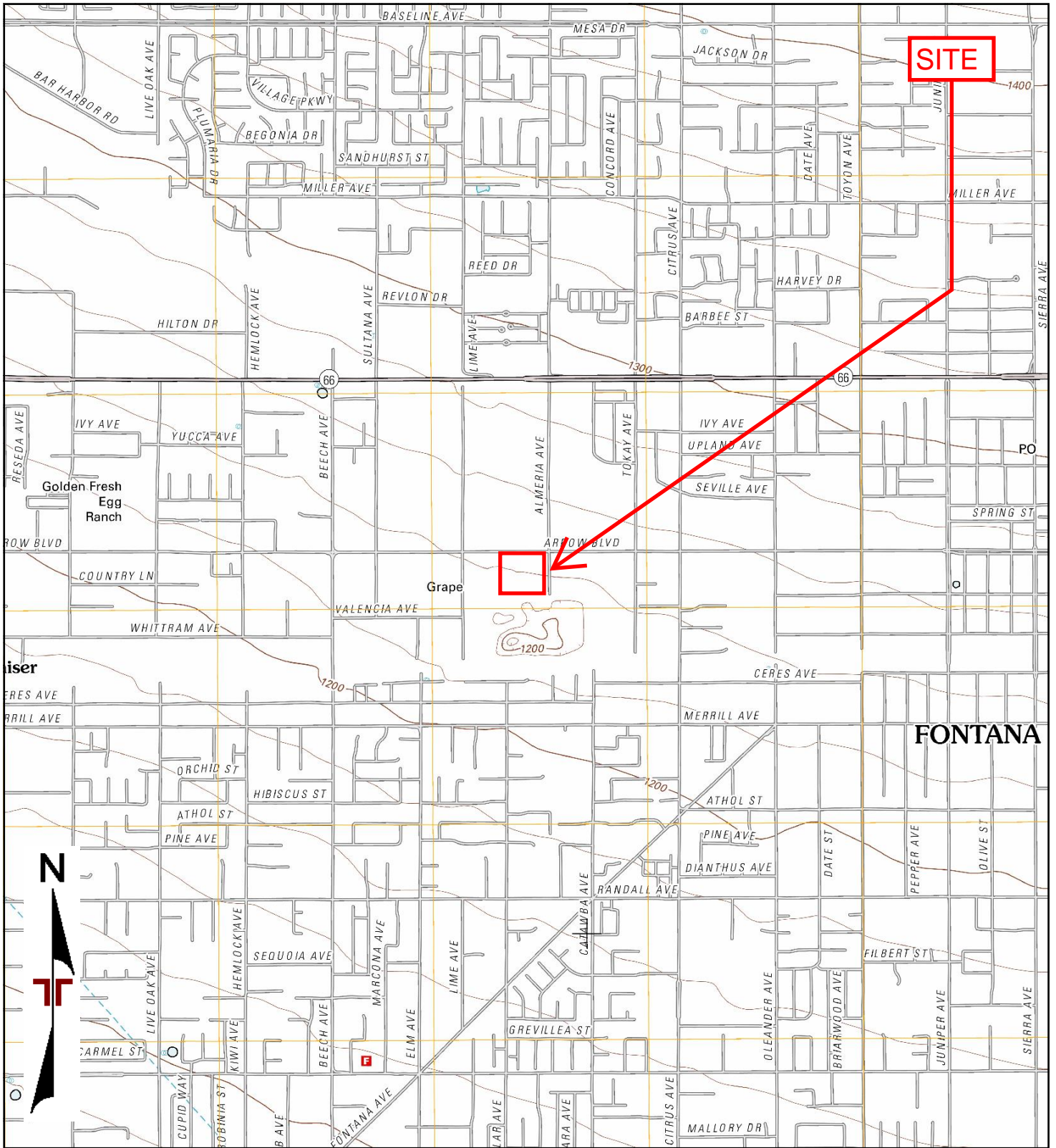

TP, Fontana, 2012, 7.5-minute

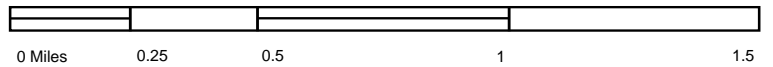

Project Manager: TGM	Project No. CB207103A
Drawn by: LSH	Scale: As Shown
Checked by: TGM	File Name: N/A
Approved by: CAP	Date: 2012

**Terracon**  
 1355 East Cooley Drive, California  
 Colton, CA 92324

**2012 TOPOGRAPHIC MAP**  
**Auto Salvage Yard - Fontana**  
 15719 - 15765 Arrow Boulevard  
 Fontana, San Bernardino County, California 92335

Exhibit  <b>1</b>
-------------------------

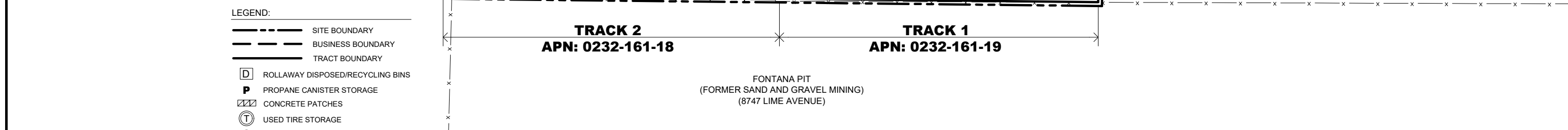
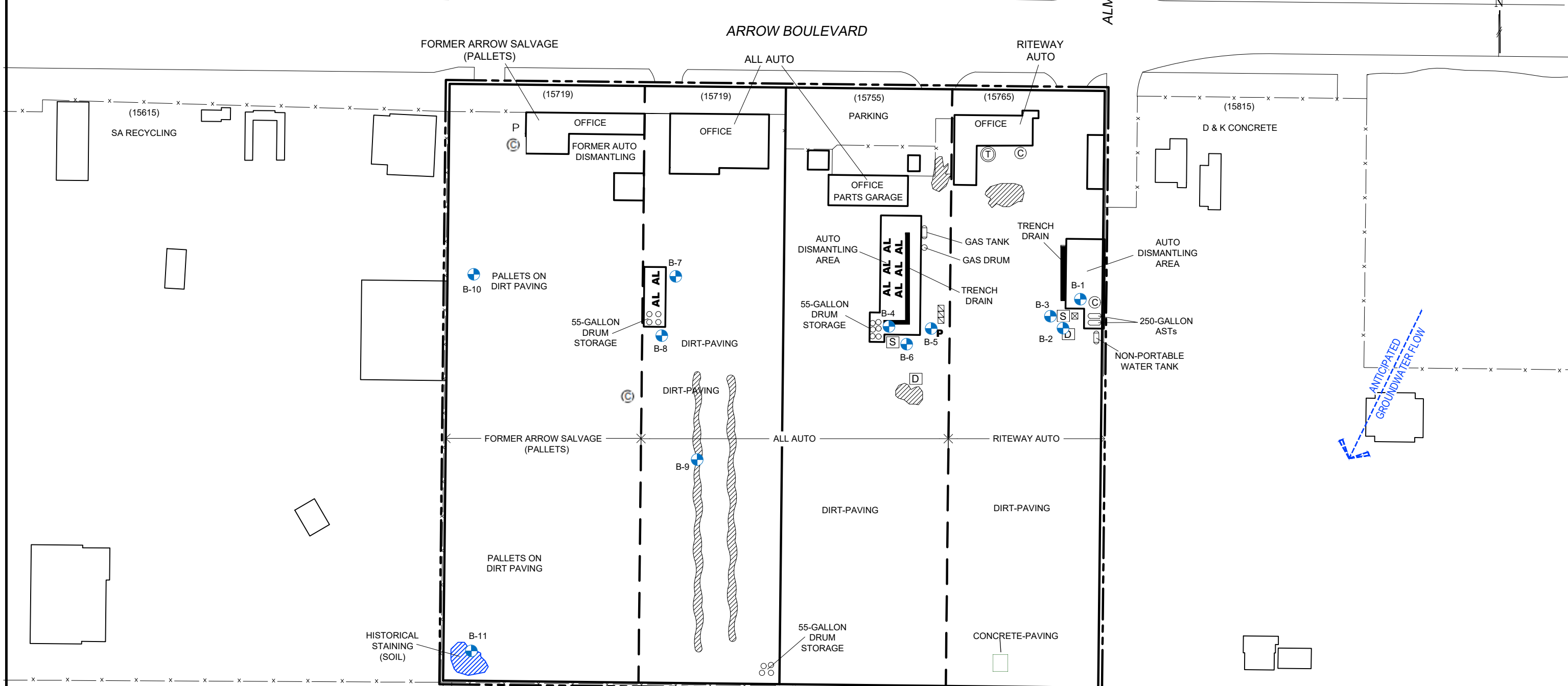
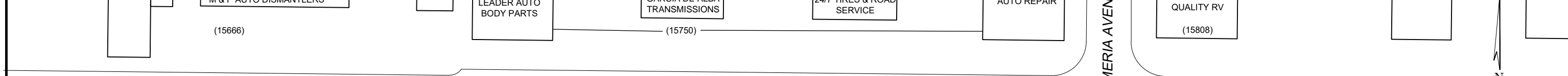

- LEGEND:**
- SITE BOUNDARY
  - BUSINESS BOUNDARY
  - TRACT BOUNDARY
  - [D] ROLLAWAY DISPOSED/RECYCLING BINS
  - [P] PROPANE CANISTER STORAGE
  - [X] CONCRETE PATCHES
  - [T] USED TIRE STORAGE
  - [C] COMPRESSOR
  - [X] WATER TOTE
  - [S] SUMP
  - [Hatched] STAINED SOIL
  - [AL] ABOVEGROUND LIFT
  - [Blue Circle] SOIL BORING (TERRACON, 10/7/2020)

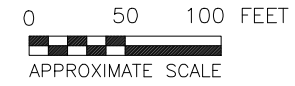

THIS DRAWING SHOULD NOT BE USED SEPARATELY FROM ORIGINAL REPORT.

Project Mngr:	LSH	Project No.	CB207103A
Drawn By:	DG	Scale:	AS SHOWN
Checked By:	TGM	Date:	10/22/20
Approved By:	CAP		

**Terracon**  
Consulting Engineers and Scientists  
1355 E. Cooley Dr., Ste. C  
Colton, CA 92324-3954

**SITE DIAGRAM**

AUTO SALVAGE YARD - FONTANA  
15719 - 15765 ARROW BOULEVARD  
FONTANA, SAN BERNARDINO COUNTY, CALIFORNIA

**APPENDIX B  
BORING LOGS**

# BORING LOG NO. B-1

**PROJECT: WPT Properties**

**CLIENT: WPT Acquisitions, LLC**

**SITE: 15719 - 15765 Arrow Blvd.  
Fontana, California**

GRAPHIC LOG	LOCATION See Exhibit A-2 Latitude: 34.098472° Longitude: -117.460434°	DEPTH (ft)	WATER LEVEL OBSERVATIONS	SAMPLE TYPE	OVA/PID (ppm)
DEPTH	MATERIAL DESCRIPTION				
0.3	<b>CONCRETE</b> , 4" thick				1.2
	<b>SILTY SAND (SM)</b> , fine grained, light brown to medium brown, weak odor, dry				1.8
	trace gravel to 1/4"				2.2
4.0	<b>SILTY SAND (SM)</b> , fine to coarse grained, light brown, no odor, dry, with gravel to 1/2"	5			0.0
					0.0
					0.0
8.0	<b>Boring Terminated at 8 Feet</b>				0.0

The stratification lines represent the approximate transition between differing soil types and/or rock types; in-situ these transitions may be gradual or may occur at different depths than shown.

Hammer Type: Automatic

Advancement Method:  
3" Direct Push

See Appendices for description of field procedures.

Notes:

Abandonment Method:  
Boring backfilled with bentonite chips  
Surface capped with concrete

See Appendices for description of laboratory procedures and additional data (if any).

See Appendices for explanation of symbols and abbreviations.

**WATER LEVEL OBSERVATIONS**  
*Groundwater not encountered*



Boring Started: 10-07-2020

Boring Completed: 10-07-2020

Drill Rig: Geoprobe 7822DT

Driller: BC2 Drilling

Project No.: CB207103A

Exhibit: B-1

THIS BORING LOG IS NOT VALID IF SEPARATED FROM ORIGINAL REPORT. ENVIRONMENTAL SMART LOG CB207103A WPT PROPERTIES.GPJ TERRACON\_DATATEMPLATE.GDT 10/19/20



# BORING LOG NO. B-2

**PROJECT: WPT Properties**

**CLIENT: WPT Acquisitions, LLC**

**SITE: 15719 - 15765 Arrow Blvd.  
Fontana, California**

GRAPHIC LOG	LOCATION See Exhibit A-2 Latitude: 34.098442° Longitude: -117.460438°	DEPTH (ft)	WATER LEVEL OBSERVATIONS	SAMPLE TYPE	OVA/PID (ppm)
DEPTH	MATERIAL DESCRIPTION				
2.0	<b>SILTY SAND WITH GRAVEL (SM)</b> , fine to coarse grained, light brown, no odor, dry, with gravel to 1"				7.3
8.0	<b>SILTY SAND (SM)</b> , fine to medium grained, light brown to orangish brown, no odor, dry, trace gravel to 1/4"				2.1
		5			0.0
					0.0
					0.0
					0.0
					0.0
10.0	<b>SILTY SAND (SM)</b> , fine to coarse grained, light brown to light gray, no odor, dry, with gravel to 1/2"				0.0
					0.0
	<b>Boring Terminated at 10 Feet</b>	10			0.0

The stratification lines represent the approximate transition between differing soil types and/or rock types; in-situ these transitions may be gradual or may occur at different depths than shown.

Hammer Type: Automatic

Advancement Method: 3" Direct Push	See Appendices for description of field procedures.  See Appendices for description of laboratory procedures and additional data (if any).  See Appendices for explanation of symbols and abbreviations.	Notes:
Abandonment Method: Boring backfilled with bentonite chips upon completion.		
<b>WATER LEVEL OBSERVATIONS</b> <i>Groundwater not encountered</i>		Boring Started: 10-07-2020 Drill Rig: DR009 Project No.: CB207103A
		Boring Completed: 10-07-2020 Driller: BC2 Drilling Exhibit: B-2

THIS BORING LOG IS NOT VALID IF SEPARATED FROM ORIGINAL REPORT. ENVIRONMENTAL SMART LOG CB207103A WPT PROPERTIES.GPJ TERRACON\_DATATEMPLATE.GDT 10/19/20

# BORING LOG NO. B-3

**PROJECT: WPT Properties**

**CLIENT: WPT Acquisitions, LLC**

**SITE: 15719 - 15765 Arrow Blvd.  
Fontana, California**

GRAPHIC LOG	LOCATION See Exhibit A-2 Latitude: 34.098457° Longitude: -117.46045°	DEPTH (ft)	WATER LEVEL OBSERVATIONS	SAMPLE TYPE	OV/APID (ppm)
DEPTH	MATERIAL DESCRIPTION				
0.5	<b>AGGREGATE BASE COURSE</b> , 6" thick				3.5
	<b>SILTY SAND (SM)</b> , fine grained, light brown to medium brown, no odor				0.0
3.0					0.0
	<b>SILTY SAND WITH GRAVEL (SM)</b> , fine to coarse grained, light brown to light grayish brown, no odor, with gravel to 1"				
5.0					
<b>Boring Terminated at 5 Feet</b>		5			

The stratification lines represent the approximate transition between differing soil types and/or rock types; in-situ these transitions may be gradual or may occur at different depths than shown.

Hammer Type: Automatic

Advancement Method: 3" Direct Push	See Appendices for description of field procedures.  See Appendices for description of laboratory procedures and additional data (if any).  See Appendices for explanation of symbols and abbreviations.	Notes:						
Abandonment Method: Boring backfilled with bentonite chips upon completion.								
<b>WATER LEVEL OBSERVATIONS</b> <i>Groundwater not encountered</i>		<table border="1" style="width: 100%; border-collapse: collapse;"> <tr> <td style="width: 50%;">Boring Started: 10-07-2020</td> <td style="width: 50%;">Boring Completed: 10-07-2020</td> </tr> <tr> <td>Drill Rig: DR009</td> <td>Driller: BC2 Drilling</td> </tr> <tr> <td>Project No.: CB207103A</td> <td>Exhibit: B-3</td> </tr> </table>	Boring Started: 10-07-2020	Boring Completed: 10-07-2020	Drill Rig: DR009	Driller: BC2 Drilling	Project No.: CB207103A	Exhibit: B-3
Boring Started: 10-07-2020	Boring Completed: 10-07-2020							
Drill Rig: DR009	Driller: BC2 Drilling							
Project No.: CB207103A	Exhibit: B-3							

THIS BORING LOG IS NOT VALID IF SEPARATED FROM ORIGINAL REPORT. ENVIRONMENTAL SMART LOG CB207103A WPT PROPERTIES.GPJ TERRACON\_DATATEMPLATE.GDT 10/19/20

# BORING LOG NO. B-4

**PROJECT: WPT Properties**

**CLIENT: WPT Acquisitions, LLC**

**SITE: 15719 - 15765 Arrow Blvd.  
Fontana, California**

GRAPHIC LOG	LOCATION See Exhibit A-2 Latitude: 34.098464° Longitude: -117.461028°	DEPTH (ft)	WATER LEVEL OBSERVATIONS	SAMPLE TYPE	OVAPID (ppm)
DEPTH	MATERIAL DESCRIPTION				
0.4	<b>CONCRETE</b> , 5" thick				
1.0	<b>SILTY SAND (SM)</b> , fine grained, brown, weak odor, moist				0.5
	<b>SILTY SAND WITH GRAVEL (SM)</b> , fine to coarse grained, light brown to light grayish brown, no odor, dry, with gravel to 3/4"				0.0
					0.0
5.0	<b>Boring Terminated at 5 Feet</b>	5			

The stratification lines represent the approximate transition between differing soil types and/or rock types; in-situ these transitions may be gradual or may occur at different depths than shown.

Hammer Type: Automatic

Advancement Method: 3" Direct Push	See Appendices for description of field procedures.  See Appendices for description of laboratory procedures and additional data (if any).  See Appendices for explanation of symbols and abbreviations.	Notes:						
Abandonment Method: Boring backfilled with bentonite chips Surface capped with concrete								
<b>WATER LEVEL OBSERVATIONS</b> <i>Groundwater not encountered</i>		<table style="width: 100%; border-collapse: collapse;"> <tr> <td style="width: 50%;">Boring Started: 10-07-2020</td> <td style="width: 50%;">Boring Completed: 10-07-2020</td> </tr> <tr> <td>Drill Rig: DR009</td> <td>Driller: BC2 Drilling</td> </tr> <tr> <td>Project No.: CB207103A</td> <td>Exhibit: B-4</td> </tr> </table>	Boring Started: 10-07-2020	Boring Completed: 10-07-2020	Drill Rig: DR009	Driller: BC2 Drilling	Project No.: CB207103A	Exhibit: B-4
Boring Started: 10-07-2020	Boring Completed: 10-07-2020							
Drill Rig: DR009	Driller: BC2 Drilling							
Project No.: CB207103A	Exhibit: B-4							

THIS BORING LOG IS NOT VALID IF SEPARATED FROM ORIGINAL REPORT. ENVIRONMENTAL SMART LOG CB207103A WPT PROPERTIES.GPJ TERRACON\_DATATEMPLATE.GDT 10/19/20

# BORING LOG NO. B-5

**PROJECT: WPT Properties**

**CLIENT: WPT Acquisitions, LLC**

**SITE: 15719 - 15765 Arrow Blvd.  
Fontana, California**

GRAPHIC LOG	LOCATION See Exhibit A-2 Latitude: 34.098484° Longitude: -117.460878°	DEPTH (ft)	WATER LEVEL OBSERVATIONS	SAMPLE TYPE	OVA/PID (ppm)
DEPTH	MATERIAL DESCRIPTION				
0.4	<b>CONCRETE</b> , 5" thick				1.7
	<b>SILTY SAND (SM)</b> , fine to coarse grained, strong odor, brown, wet, trace gravel to 1"				0.3
3.0	<b>SILTY SAND WITH GRAVEL (SM)</b> , fine to coarse grained, light brown to grayish brown, dry, with gravel to 1"				0.0
5.0	<b>Boring Terminated at 5 Feet</b>	5			0.0

The stratification lines represent the approximate transition between differing soil types and/or rock types; in-situ these transitions may be gradual or may occur at different depths than shown.

Hammer Type: Automatic

Advancement Method:  
3" Direct Push

See Appendices for description of field procedures.

Notes:

Abandonment Method:  
Boring backfilled with bentonite chips  
Surface capped with concrete

See Appendices for description of laboratory procedures and additional data (if any).  
See Appendices for explanation of symbols and abbreviations.

**WATER LEVEL OBSERVATIONS**  
*Groundwater not encountered*



Boring Started: 10-07-2020

Boring Completed: 10-07-2020

Drill Rig: DR009

Driller: BC2 Drilling

Project No.: CB207103A

Exhibit: B-5

THIS BORING LOG IS NOT VALID IF SEPARATED FROM ORIGINAL REPORT. ENVIRONMENTAL SMART LOG CB207103A WPT PROPERTIES.GPJ TERRACON\_DATATEMPLATE.GDT 10/19/20

# BORING LOG NO. B-6

**PROJECT: WPT Properties**

**CLIENT: WPT Acquisitions, LLC**

**SITE: 15719 - 15765 Arrow Blvd.  
Fontana, California**

GRAPHIC LOG	LOCATION See Exhibit A-2 Latitude: 34.098443° Longitude: -117.461028°	DEPTH (ft)	WATER LEVEL OBSERVATIONS	SAMPLE TYPE	OVAPID (ppm)
DEPTH	MATERIAL DESCRIPTION				
1.5	<b>SILTY SAND WITH GRAVEL (SM)</b> , fine to coarse grained, grayish brown to brown, no odor, moist, with gravel to 1"				29.7
3.5	<b>SILTY SAND WITH GRAVEL (SM)</b> , fine grained, brown, no odor, moist, with gravel to 1/4"				14.8
5.0	<b>SILTY SAND WITH GRAVEL (SM)</b> , fine to coarse grained, light brown to light grayish brown, no odor, dry, with gravel to 1/4"				33.9
<b>Boring Terminated at 5 Feet</b>		5			

The stratification lines represent the approximate transition between differing soil types and/or rock types; in-situ these transitions may be gradual or may occur at different depths than shown.

Hammer Type: Automatic

Advancement Method:  
3" Direct Push

See Appendices for description of field procedures.

Notes:

Abandonment Method:  
Boring backfilled with bentonite chips upon completion.

See Appendices for description of laboratory procedures and additional data (if any).

See Appendices for explanation of symbols and abbreviations.

**WATER LEVEL OBSERVATIONS**  
*Groundwater not encountered*



Boring Started: 10-07-2020

Boring Completed: 10-07-2020

Drill Rig: DR009

Driller: BC2 Drilling

Project No.: CB207103A

Exhibit: B-6

THIS BORING LOG IS NOT VALID IF SEPARATED FROM ORIGINAL REPORT. ENVIRONMENTAL SMART LOG CB207103A WPT PROPERTIES.GPJ TERRACON\_DATATEMPLATE.GDT 10/19/20

# BORING LOG NO. B-7

**PROJECT: WPT Properties**

**CLIENT: WPT Acquisitions, LLC**

**SITE: 15719 - 15765 Arrow Blvd.  
Fontana, California**

GRAPHIC LOG	LOCATION See Exhibit A-2 Latitude: 34.098657° Longitude: -117.46179°	DEPTH (ft)	WATER LEVEL OBSERVATIONS	SAMPLE TYPE	OV/APID (ppm)
DEPTH	MATERIAL DESCRIPTION				
0.4	<b>ASPHALT</b> , 5" thick				0.0
4.0	<b>SILTY SAND (SM)</b> , fine to medium grained, medium brown, no odor, moist, trace gravel to 1/4"				0.0
5.0	<b>SILTY SAND WITH GRAVEL (SM)</b> , fine to coarse grained, light brown to light grayish brown, no odor, dry, with gravel to 3/4"				0.0
	<b>Boring Terminated at 5 Feet</b>	5			

The stratification lines represent the approximate transition between differing soil types and/or rock types; in-situ these transitions may be gradual or may occur at different depths than shown.

Hammer Type: Automatic

Advancement Method: 3" Direct Push	See Appendices for description of field procedures.  See Appendices for description of laboratory procedures and additional data (if any).  See Appendices for explanation of symbols and abbreviations.	Notes:						
Abandonment Method: Boring backfilled with bentonite chips Surface capped with concrete								
<b>WATER LEVEL OBSERVATIONS</b> <i>Groundwater not encountered</i>		<table border="1" style="width: 100%; border-collapse: collapse;"> <tr> <td style="width: 50%;">Boring Started: 10-07-2020</td> <td style="width: 50%;">Boring Completed: 10-07-2020</td> </tr> <tr> <td>Drill Rig: DR009</td> <td>Driller: BC2 Drilling</td> </tr> <tr> <td>Project No.: CB207103A</td> <td>Exhibit: B-7</td> </tr> </table>	Boring Started: 10-07-2020	Boring Completed: 10-07-2020	Drill Rig: DR009	Driller: BC2 Drilling	Project No.: CB207103A	Exhibit: B-7
Boring Started: 10-07-2020	Boring Completed: 10-07-2020							
Drill Rig: DR009	Driller: BC2 Drilling							
Project No.: CB207103A	Exhibit: B-7							

THIS BORING LOG IS NOT VALID IF SEPARATED FROM ORIGINAL REPORT. ENVIRONMENTAL SMART LOG CB207103A WPT PROPERTIES.GPJ TERRACON\_DATATEMPLATE.GDT 10/19/20

# BORING LOG NO. B-8

**PROJECT: WPT Properties**

**CLIENT: WPT Acquisitions, LLC**

**SITE: 15719 - 15765 Arrow Blvd.  
Fontana, California**

GRAPHIC LOG	LOCATION See Exhibit A-2 Latitude: 34.098459° Longitude: -117.461789°	DEPTH (ft)	WATER LEVEL OBSERVATIONS	SAMPLE TYPE	OV/APID (ppm)
DEPTH	MATERIAL DESCRIPTION				
3.0	<b>SILTY SAND (SM)</b> , fine grained, medium brown, no odor, moist, trace gravel to 1/4"	3.1			
5.0	<b>SILTY SAND WITH GRAVEL (SM)</b> , fine to coarse grained, light brown to light grayish brown, no odor, dry, with gravel to 3/4"	1.5			
	<b>Boring Terminated at 5 Feet</b>	1.1			
		5			

The stratification lines represent the approximate transition between differing soil types and/or rock types; in-situ these transitions may be gradual or may occur at different depths than shown.

Hammer Type: Automatic

Advancement Method: 3" Direct Push	See Appendices for description of field procedures.  See Appendices for description of laboratory procedures and additional data (if any).  See Appendices for explanation of symbols and abbreviations.	Notes:
Abandonment Method: Boring backfilled with bentonite chips upon completion.		
<b>WATER LEVEL OBSERVATIONS</b> <i>Groundwater not encountered</i>		Boring Started: 10-07-2020 Drill Rig: DR009 Project No.: CB207103A
		Boring Completed: 10-07-2020 Driller: BC2 Drilling Exhibit: B-8

THIS BORING LOG IS NOT VALID IF SEPARATED FROM ORIGINAL REPORT. ENVIRONMENTAL SMART LOG CB207103A WPT PROPERTIES.GPJ TERRACON\_DATATEMPLATE.GDT 10/19/20



# BORING LOG NO. B-9

**PROJECT: WPT Properties**

**CLIENT: WPT Acquisitions, LLC**

**SITE: 15719 - 15765 Arrow Blvd.  
Fontana, California**

GRAPHIC LOG	LOCATION See Exhibit A-2  Latitude: 34.098121° Longitude: -117.461674°	DEPTH (ft)	WATER LEVEL OBSERVATIONS	SAMPLE TYPE	OVAPID (ppm)
-------------	--	------------	--------------------------	-------------	--------------

DEPTH	MATERIAL DESCRIPTION				
5.0	<b>SILTY SAND WITH GRAVEL (SM)</b> , fine to coarse grained, light brown, no odor, dry, with gravel to 3/8"	5			5.2 0.2 0.0

**Boring Terminated at 5 Feet**

The stratification lines represent the approximate transition between differing soil types and/or rock types; in-situ these transitions may be gradual or may occur at different depths than shown. Hammer Type: Automatic

Advancement Method: 3" Direct Push	See Appendices for description of field procedures.  See Appendices for description of laboratory procedures and additional data (if any).  See Appendices for explanation of symbols and abbreviations.	Notes:	
Abandonment Method: Boring backfilled with bentonite chips upon completion.			
<b>WATER LEVEL OBSERVATIONS</b> <i>Groundwater not encountered</i>		Boring Started: 10-07-2020 Drill Rig: DR009 Project No.: CB207103A	Boring Completed: 10-07-2020 Driller: BC2 Drilling Exhibit: B-9

THIS BORING LOG IS NOT VALID IF SEPARATED FROM ORIGINAL REPORT. ENVIRONMENTAL SMART LOG CB207103A WPT PROPERTIES.GPJ TERRACON\_DATATEMPLATE.GDT 10/19/20

# BORING LOG NO. B-10

**PROJECT: WPT Properties**

**CLIENT: WPT Acquisitions, LLC**

**SITE: 15719 - 15765 Arrow Blvd.  
Fontana, California**

GRAPHIC LOG	LOCATION See Exhibit A-2 Latitude: 34.098° Longitude: -117.461°	DEPTH (ft)	WATER LEVEL OBSERVATIONS	SAMPLE TYPE	OVA/PID (ppm)
DEPTH	MATERIAL DESCRIPTION				
0.3	<b>CONCRETE</b> , 4" thick				0.0
2.0	<b>SILTY SAND (SM)</b> , fine grained, brown, no odor, moist, trace gravel to 1/2"				0.0
5.0	<b>SILTY SAND WITH GRAVEL (SM)</b> , fine to coarse grained, light brown to light grayish brown, no odor, dry, with gravel to 1"				0.0
<b>Boring Terminated at 5 Feet</b>		5			

The stratification lines represent the approximate transition between differing soil types and/or rock types; in-situ these transitions may be gradual or may occur at different depths than shown.

Hammer Type: Automatic

Advancement Method: 3" Direct Push	See Appendices for description of field procedures.  See Appendices for description of laboratory procedures and additional data (if any).  See Appendices for explanation of symbols and abbreviations.	Notes:						
Abandonment Method: Boring backfilled with bentonite chips upon completion.								
<b>WATER LEVEL OBSERVATIONS</b> <i>Groundwater not encountered</i>		<table border="1" style="width: 100%; border-collapse: collapse;"> <tr> <td style="width: 50%;">Boring Started: 10-07-2020</td> <td style="width: 50%;">Boring Completed: 10-07-2020</td> </tr> <tr> <td>Drill Rig: DR009</td> <td>Driller: BC2 Drilling</td> </tr> <tr> <td>Project No.: CB207103A</td> <td>Exhibit: B-10</td> </tr> </table>	Boring Started: 10-07-2020	Boring Completed: 10-07-2020	Drill Rig: DR009	Driller: BC2 Drilling	Project No.: CB207103A	Exhibit: B-10
Boring Started: 10-07-2020	Boring Completed: 10-07-2020							
Drill Rig: DR009	Driller: BC2 Drilling							
Project No.: CB207103A	Exhibit: B-10							

THIS BORING LOG IS NOT VALID IF SEPARATED FROM ORIGINAL REPORT. ENVIRONMENTAL SMART LOG CB207103A WPT PROPERTIES.GPJ TERRACON\_DATATEMPLATE.GDT 10/19/20

# BORING LOG NO. B-11

**PROJECT: WPT Properties**

**CLIENT: WPT Acquisitions, LLC**

**SITE: 15719 - 15765 Arrow Blvd.  
Fontana, California**

GRAPHIC LOG	LOCATION See Exhibit A-2 Latitude: 34.09759° Longitude: -117.462402°	DEPTH (ft)	WATER LEVEL OBSERVATIONS	SAMPLE TYPE	OVA/PID (ppm)
DEPTH	MATERIAL DESCRIPTION				
2.0	<b>FILL - SILTY SAND (SM)</b> , fine grained, light grayish brown, no odor, dry	4.8			
5.0	<b>SILTY SAND WITH GRAVEL (SM)</b> , fine to coarse grained, light brown to light grayish brown, no odor, dry, with gravel to 1"	0.3			
	<b>Boring Terminated at 5 Feet</b>	0.0			
		5			

The stratification lines represent the approximate transition between differing soil types and/or rock types; in-situ these transitions may be gradual or may occur at different depths than shown.

Hammer Type: Automatic

Advancement Method: 3" Direct Push	See Appendices for description of field procedures.  See Appendices for description of laboratory procedures and additional data (if any).  See Appendices for explanation of symbols and abbreviations.	Notes:
Abandonment Method: Boring backfilled with bentonite chips upon completion.		
<b>WATER LEVEL OBSERVATIONS</b> <i>Groundwater not encountered</i>		Boring Started: 10-07-2020 Drill Rig: DR009 Project No.: CB207103A
		Boring Completed: 10-07-2020 Driller: BC2 Drilling Exhibit: B-11

THIS BORING LOG IS NOT VALID IF SEPARATED FROM ORIGINAL REPORT. ENVIRONMENTAL SMART LOG CB207103A WPT PROPERTIES.GPJ TERRACON\_DATATEMPLATE.GDT 10/19/20

**APPENDIX C**  
**ANALYTICAL REPORT AND CHAIN-OF-CUSTODY**



25712 Commercentre Drive  
Lake Forest, California 92630  
949.297.5020 Phone  
949.297.5027 Fax

12 October 2020

Todd McFarland  
Terracon - Colton  
1355 East Cooley Dr.  
Colton, CA 92324  
RE: WPT Property Fontana

Enclosed are the results of analyses for samples received by the laboratory on 10/08/20 16:30. If you have any questions concerning this report, please feel free to contact me.

Sincerely,

Jeff Lee  
Project Manager



25712 Commercentre Drive  
 Lake Forest, California 92630  
 949.297.5020 Phone  
 949.297.5027 Fax

Terracon - Colton  
 1355 East Cooley Dr.  
 Colton CA, 92324

Project: WPT Property Fontana  
 Project Number: CB207103A  
 Project Manager: Todd McFarland

**Reported:**  
 10/12/20 18:08

**ANALYTICAL REPORT FOR SAMPLES**

Sample ID	Laboratory ID	Matrix	Date Sampled	Date Received
SB-1-8	T203530-02	Soil	10/07/20 09:15	10/08/20 16:30
SB-2-10	T203530-04	Soil	10/07/20 09:35	10/08/20 16:30
SB-3-5	T203530-05	Soil	10/07/20 10:00	10/08/20 16:30
SB-4-5	T203530-06	Soil	10/07/20 10:35	10/08/20 16:30
SB-5-5	T203530-07	Soil	10/07/20 11:02	10/08/20 16:30
SB-6-3	T203530-08	Soil	10/07/20 11:18	10/08/20 16:30
SB-6-5	T203530-09	Soil	10/07/20 11:24	10/08/20 16:30
SB-7-5	T203530-10	Soil	10/07/20 12:25	10/08/20 16:30
SB-8-5	T203530-11	Soil	10/07/20 12:40	10/08/20 16:30
SB-9-5	T203530-12	Soil	10/07/20 12:55	10/08/20 16:30
SB-10-5	T203530-13	Soil	10/07/20 13:27	10/08/20 16:30
SB-11-5	T203530-14	Soil	10/07/20 13:45	10/08/20 16:30

SunStar Laboratories, Inc.

*The results in this report apply to the samples analyzed in accordance with the chain of custody document. This analytical report must be reproduced in its entirety.*

Jeff Lee, Project Manager

Terracon - Colton  
1355 East Cooley Dr.  
Colton CA, 92324

Project: WPT Property Fontana  
Project Number: CB207103A  
Project Manager: Todd McFarland

**Reported:**  
10/12/20 18:08

**DETECTIONS SUMMARY**

**Sample ID:** SB-1-8

**Laboratory ID:** T203530-02

No Results Detected

**Sample ID:** SB-2-10

**Laboratory ID:** T203530-04

Analyte	Result	Reporting		Units	Method	Notes
		Limit				
Barium	35	1.0		mg/kg	EPA 6010b	
Chromium	10	2.0		mg/kg	EPA 6010b	
Cobalt	3.6	2.0		mg/kg	EPA 6010b	
Copper	8.6	1.0		mg/kg	EPA 6010b	
Nickel	5.9	2.0		mg/kg	EPA 6010b	
Vanadium	20	5.0		mg/kg	EPA 6010b	
Zinc	23	1.0		mg/kg	EPA 6010b	

**Sample ID:** SB-3-5

**Laboratory ID:** T203530-05

No Results Detected

**Sample ID:** SB-4-5

**Laboratory ID:** T203530-06

No Results Detected

**Sample ID:** SB-5-5

**Laboratory ID:** T203530-07

No Results Detected

SunStar Laboratories, Inc.



*The results in this report apply to the samples analyzed in accordance with the chain of custody document. This analytical report must be reproduced in its entirety.*

Jeff Lee, Project Manager



Terracon - Colton  
1355 East Cooley Dr.  
Colton CA, 92324

Project: WPT Property Fontana  
Project Number: CB207103A  
Project Manager: Todd McFarland

**Reported:**  
10/12/20 18:08

**Sample ID:** SB-6-3

**Laboratory ID:** T203530-08

Analyte	Result	Reporting		Units	Method	Notes
		Limit				
C13-C28 (DRO)	12	10		mg/kg	EPA 8015B	
C29-C40 (MORO)	63	10		mg/kg	EPA 8015B	
Barium	27	1.0		mg/kg	EPA 6010b	
Chromium	7.7	2.0		mg/kg	EPA 6010b	
Cobalt	4.2	2.0		mg/kg	EPA 6010b	
Copper	4.9	1.0		mg/kg	EPA 6010b	
Nickel	5.1	2.0		mg/kg	EPA 6010b	
Vanadium	16	5.0		mg/kg	EPA 6010b	
Zinc	23	1.0		mg/kg	EPA 6010b	
Ethylbenzene	0.0034	0.0025		mg/kg	EPA 8260B	
m,p-Xylene	0.023	0.0050		mg/kg	EPA 8260B	
o-Xylene	0.0097	0.0025		mg/kg	EPA 8260B	

**Sample ID:** SB-6-5

**Laboratory ID:** T203530-09

Analyte	Result	Reporting		Units	Method	Notes
		Limit				
C13-C28 (DRO)	11	10		mg/kg	EPA 8015B	

**Sample ID:** SB-7-5

**Laboratory ID:** T203530-10

No Results Detected

**Sample ID:** SB-8-5

**Laboratory ID:** T203530-11

No Results Detected

**Sample ID:** SB-9-5

**Laboratory ID:** T203530-12

No Results Detected

SunStar Laboratories, Inc.



*The results in this report apply to the samples analyzed in accordance with the chain of custody document. This analytical report must be reproduced in its entirety.*

Jeff Lee, Project Manager



25712 Commercentre Drive  
Lake Forest, California 92630  
949.297.5020 Phone  
949.297.5027 Fax

Terracon - Colton  
1355 East Cooley Dr.  
Colton CA, 92324

Project: WPT Property Fontana  
Project Number: CB207103A  
Project Manager: Todd McFarland

**Reported:**  
10/12/20 18:08

**Sample ID:** SB-10-5

**Laboratory ID:** T203530-13

No Results Detected

**Sample ID:** SB-11-5

**Laboratory ID:** T203530-14

No Results Detected

SunStar Laboratories, Inc.

*The results in this report apply to the samples analyzed in accordance with the chain of custody document. This analytical report must be reproduced in its entirety.*

Jeff Lee, Project Manager

Terracon - Colton  
1355 East Cooley Dr.  
Colton CA, 92324

Project: WPT Property Fontana  
Project Number: CB207103A  
Project Manager: Todd McFarland

Reported:  
10/12/20 18:08

**SB-1-8**  
**T203530-02 (Soil)**

Analyte	Result	Reporting Limit	Units	Dilution	Batch	Prepared	Analyzed	Method	Notes
---------	--------	-----------------	-------	----------	-------	----------	----------	--------	-------

**SunStar Laboratories, Inc.**

**Extractable Petroleum Hydrocarbons by 8015B**

C6-C12 (GRO)	ND	10	mg/kg	1	0100905	10/09/20	10/10/20	EPA 8015B	
C13-C28 (DRO)	ND	10	"	"	"	"	"	"	
C29-C40 (MORO)	ND	10	"	"	"	"	"	"	
Surrogate: <i>p</i> -Terphenyl		70.9 %	65-135		"	"	"	"	

**Volatile Organic Compounds by EPA Method 8260B**

Bromobenzene	ND	0.0025	mg/kg	1	0100931	10/09/20	10/09/20	EPA 8260B	
Bromochloromethane	ND	0.0025	"	"	"	"	"	"	
Bromodichloromethane	ND	0.0025	"	"	"	"	"	"	
Bromoform	ND	0.0025	"	"	"	"	"	"	
Bromomethane	ND	0.0025	"	"	"	"	"	"	
n-Butylbenzene	ND	0.0025	"	"	"	"	"	"	
sec-Butylbenzene	ND	0.0025	"	"	"	"	"	"	
tert-Butylbenzene	ND	0.0025	"	"	"	"	"	"	
Carbon tetrachloride	ND	0.0025	"	"	"	"	"	"	
Chlorobenzene	ND	0.0025	"	"	"	"	"	"	
Chloroethane	ND	0.0025	"	"	"	"	"	"	
Chloroform	ND	0.0025	"	"	"	"	"	"	
Chloromethane	ND	0.0025	"	"	"	"	"	"	
2-Chlorotoluene	ND	0.0025	"	"	"	"	"	"	
4-Chlorotoluene	ND	0.0025	"	"	"	"	"	"	
Dibromochloromethane	ND	0.0025	"	"	"	"	"	"	
1,2-Dibromo-3-chloropropane	ND	0.0050	"	"	"	"	"	"	
1,2-Dibromoethane (EDB)	ND	0.0025	"	"	"	"	"	"	
Dibromomethane	ND	0.0025	"	"	"	"	"	"	
1,2-Dichlorobenzene	ND	0.0025	"	"	"	"	"	"	
1,3-Dichlorobenzene	ND	0.0025	"	"	"	"	"	"	
1,4-Dichlorobenzene	ND	0.0025	"	"	"	"	"	"	
Dichlorodifluoromethane	ND	0.0025	"	"	"	"	"	"	
1,1-Dichloroethane	ND	0.0025	"	"	"	"	"	"	
1,2-Dichloroethane	ND	0.0025	"	"	"	"	"	"	
1,1-Dichloroethene	ND	0.0025	"	"	"	"	"	"	

SunStar Laboratories, Inc.



Jeff Lee, Project Manager

*The results in this report apply to the samples analyzed in accordance with the chain of custody document. This analytical report must be reproduced in its entirety.*

Terracon - Colton  
 1355 East Cooley Dr.  
 Colton CA, 92324

Project: WPT Property Fontana  
 Project Number: CB207103A  
 Project Manager: Todd McFarland

Reported:  
 10/12/20 18:08

**SB-1-8**  
**T203530-02 (Soil)**

Analyte	Result	Reporting Limit	Units	Dilution	Batch	Prepared	Analyzed	Method	Notes
---------	--------	-----------------	-------	----------	-------	----------	----------	--------	-------

**SunStar Laboratories, Inc.**

**Volatile Organic Compounds by EPA Method 8260B**

Analyte	Result	Reporting Limit	Units	Dilution	Batch	Prepared	Analyzed	Method	Notes
cis-1,2-Dichloroethene	ND	0.0025	mg/kg	1	0100931	10/09/20	10/09/20	EPA 8260B	
trans-1,2-Dichloroethene	ND	0.0025	"	"	"	"	"	"	
1,2-Dichloropropane	ND	0.0025	"	"	"	"	"	"	
1,3-Dichloropropane	ND	0.0025	"	"	"	"	"	"	
2,2-Dichloropropane	ND	0.0025	"	"	"	"	"	"	
1,1-Dichloropropene	ND	0.0025	"	"	"	"	"	"	
cis-1,3-Dichloropropene	ND	0.0025	"	"	"	"	"	"	
trans-1,3-Dichloropropene	ND	0.0025	"	"	"	"	"	"	
Hexachlorobutadiene	ND	0.0025	"	"	"	"	"	"	
Isopropylbenzene	ND	0.0025	"	"	"	"	"	"	
p-Isopropyltoluene	ND	0.0025	"	"	"	"	"	"	
Methylene chloride	ND	0.010	"	"	"	"	"	"	
Naphthalene	ND	0.0025	"	"	"	"	"	"	
n-Propylbenzene	ND	0.0025	"	"	"	"	"	"	
Styrene	ND	0.0025	"	"	"	"	"	"	
1,1,2,2-Tetrachloroethane	ND	0.0025	"	"	"	"	"	"	
1,1,1,2-Tetrachloroethane	ND	0.0025	"	"	"	"	"	"	
Tetrachloroethene	ND	0.0025	"	"	"	"	"	"	
1,2,3-Trichlorobenzene	ND	0.0025	"	"	"	"	"	"	
1,2,4-Trichlorobenzene	ND	0.0025	"	"	"	"	"	"	
1,1,2-Trichloroethane	ND	0.0025	"	"	"	"	"	"	
1,1,1-Trichloroethane	ND	0.0025	"	"	"	"	"	"	
Trichloroethene	ND	0.0025	"	"	"	"	"	"	
Trichlorofluoromethane	ND	0.0025	"	"	"	"	"	"	
1,2,3-Trichloropropane	ND	0.0025	"	"	"	"	"	"	
1,3,5-Trimethylbenzene	ND	0.0025	"	"	"	"	"	"	
1,2,4-Trimethylbenzene	ND	0.0025	"	"	"	"	"	"	
Vinyl chloride	ND	0.0025	"	"	"	"	"	"	
Benzene	ND	0.0025	"	"	"	"	"	"	
Toluene	ND	0.0025	"	"	"	"	"	"	
Ethylbenzene	ND	0.0025	"	"	"	"	"	"	
m,p-Xylene	ND	0.0050	"	"	"	"	"	"	

SunStar Laboratories, Inc.



The results in this report apply to the samples analyzed in accordance with the chain of custody document. This analytical report must be reproduced in its entirety.

Jeff Lee, Project Manager

Terracon - Colton  
1355 East Cooley Dr.  
Colton CA, 92324

Project: WPT Property Fontana  
Project Number: CB207103A  
Project Manager: Todd McFarland

**Reported:**  
10/12/20 18:08

**SB-1-8**  
**T203530-02 (Soil)**

Analyte	Result	Reporting Limit	Units	Dilution	Batch	Prepared	Analyzed	Method	Notes
---------	--------	--------------------	-------	----------	-------	----------	----------	--------	-------

**SunStar Laboratories, Inc.**

**Volatile Organic Compounds by EPA Method 8260B**

Analyte	Result	Reporting Limit	Units	Dilution	Batch	Prepared	Analyzed	Method	Notes
o-Xylene	ND	0.0025	mg/kg	1	0100931	10/09/20	10/09/20	EPA 8260B	
Surrogate: 4-Bromofluorobenzene	101 %	75.4-139			"	"	"	"	
Surrogate: Dibromofluoromethane	92.9 %	73.1-125			"	"	"	"	
Surrogate: Toluene-d8	97.7 %	82.6-117			"	"	"	"	

SunStar Laboratories, Inc.



*The results in this report apply to the samples analyzed in accordance with the chain of custody document. This analytical report must be reproduced in its entirety.*

Jeff Lee, Project Manager

Terracon - Colton  
1355 East Cooley Dr.  
Colton CA, 92324

Project: WPT Property Fontana  
Project Number: CB207103A  
Project Manager: Todd McFarland

**Reported:**  
10/12/20 18:08

**SB-2-10**  
**T203530-04 (Soil)**

Analyte	Result	Reporting Limit	Units	Dilution	Batch	Prepared	Analyzed	Method	Notes
---------	--------	-----------------	-------	----------	-------	----------	----------	--------	-------

**SunStar Laboratories, Inc.**

**Extractable Petroleum Hydrocarbons by 8015B**

C6-C12 (GRO)	ND	10	mg/kg	1	0100905	10/09/20	10/10/20	EPA 8015B	
C13-C28 (DRO)	ND	10	"	"	"	"	"	"	
C29-C40 (MORO)	ND	10	"	"	"	"	"	"	
<i>Surrogate: p-Terphenyl</i>		88.1 %		65-135	"	"	"	"	

**Metals by EPA 6010B**

Antimony	ND	3.0	mg/kg	1	0100833	10/08/20	10/12/20	EPA 6010b	
Silver	ND	2.0	"	"	"	"	"	"	
Arsenic	ND	5.0	"	"	"	"	"	"	
<b>Barium</b>	<b>35</b>	1.0	"	"	"	"	"	"	
Beryllium	ND	1.0	"	"	"	"	10/12/20	"	
Cadmium	ND	2.0	"	"	"	"	10/12/20	"	
<b>Chromium</b>	<b>10</b>	2.0	"	"	"	"	"	"	
<b>Cobalt</b>	<b>3.6</b>	2.0	"	"	"	"	"	"	
<b>Copper</b>	<b>8.6</b>	1.0	"	"	"	"	"	"	
Lead	ND	3.0	"	"	"	"	"	"	
Molybdenum	ND	5.0	"	"	"	"	"	"	
<b>Nickel</b>	<b>5.9</b>	2.0	"	"	"	"	"	"	
Selenium	ND	5.0	"	"	"	"	"	"	
Thallium	ND	5.0	"	"	"	"	"	"	
<b>Vanadium</b>	<b>20</b>	5.0	"	"	"	"	"	"	
<b>Zinc</b>	<b>23</b>	1.0	"	"	"	"	"	"	

**Cold Vapor Extraction EPA 7470/7471**

Mercury	ND	0.10	mg/kg	1	0100834	10/08/20	10/12/20	EPA 7471A Soil	
---------	----	------	-------	---	---------	----------	----------	-------------------	--

SunStar Laboratories, Inc.



Jeff Lee, Project Manager

*The results in this report apply to the samples analyzed in accordance with the chain of custody document. This analytical report must be reproduced in its entirety.*

Terracon - Colton  
 1355 East Cooley Dr.  
 Colton CA, 92324

Project: WPT Property Fontana  
 Project Number: CB207103A  
 Project Manager: Todd McFarland

Reported:  
 10/12/20 18:08

**SB-2-10**  
**T203530-04 (Soil)**

Analyte	Result	Reporting Limit	Units	Dilution	Batch	Prepared	Analyzed	Method	Notes
---------	--------	-----------------	-------	----------	-------	----------	----------	--------	-------

**SunStar Laboratories, Inc.**

**Volatile Organic Compounds by EPA Method 8260B**

Analyte	Result	Reporting Limit	Units	Dilution	Batch	Prepared	Analyzed	Method
Bromobenzene	ND	0.0025	mg/kg	1	0100931	10/09/20	10/09/20	EPA 8260B
Bromochloromethane	ND	0.0025	"	"	"	"	"	"
Bromodichloromethane	ND	0.0025	"	"	"	"	"	"
Bromoform	ND	0.0025	"	"	"	"	"	"
Bromomethane	ND	0.0025	"	"	"	"	"	"
n-Butylbenzene	ND	0.0025	"	"	"	"	"	"
sec-Butylbenzene	ND	0.0025	"	"	"	"	"	"
tert-Butylbenzene	ND	0.0025	"	"	"	"	"	"
Carbon tetrachloride	ND	0.0025	"	"	"	"	"	"
Chlorobenzene	ND	0.0025	"	"	"	"	"	"
Chloroethane	ND	0.0025	"	"	"	"	"	"
Chloroform	ND	0.0025	"	"	"	"	"	"
Chloromethane	ND	0.0025	"	"	"	"	"	"
2-Chlorotoluene	ND	0.0025	"	"	"	"	"	"
4-Chlorotoluene	ND	0.0025	"	"	"	"	"	"
Dibromochloromethane	ND	0.0025	"	"	"	"	"	"
1,2-Dibromo-3-chloropropane	ND	0.0050	"	"	"	"	"	"
1,2-Dibromoethane (EDB)	ND	0.0025	"	"	"	"	"	"
Dibromomethane	ND	0.0025	"	"	"	"	"	"
1,2-Dichlorobenzene	ND	0.0025	"	"	"	"	"	"
1,3-Dichlorobenzene	ND	0.0025	"	"	"	"	"	"
1,4-Dichlorobenzene	ND	0.0025	"	"	"	"	"	"
Dichlorodifluoromethane	ND	0.0025	"	"	"	"	"	"
1,1-Dichloroethane	ND	0.0025	"	"	"	"	"	"
1,2-Dichloroethane	ND	0.0025	"	"	"	"	"	"
1,1-Dichloroethene	ND	0.0025	"	"	"	"	"	"
cis-1,2-Dichloroethene	ND	0.0025	"	"	"	"	"	"
trans-1,2-Dichloroethene	ND	0.0025	"	"	"	"	"	"
1,2-Dichloropropane	ND	0.0025	"	"	"	"	"	"
1,3-Dichloropropane	ND	0.0025	"	"	"	"	"	"
2,2-Dichloropropane	ND	0.0025	"	"	"	"	"	"
1,1-Dichloropropene	ND	0.0025	"	"	"	"	"	"

SunStar Laboratories, Inc.



The results in this report apply to the samples analyzed in accordance with the chain of custody document. This analytical report must be reproduced in its entirety.

Jeff Lee, Project Manager

Terracon - Colton  
 1355 East Cooley Dr.  
 Colton CA, 92324

Project: WPT Property Fontana  
 Project Number: CB207103A  
 Project Manager: Todd McFarland

**Reported:**  
 10/12/20 18:08

**SB-2-10**  
**T203530-04 (Soil)**

Analyte	Result	Reporting Limit	Units	Dilution	Batch	Prepared	Analyzed	Method	Notes
---------	--------	-----------------	-------	----------	-------	----------	----------	--------	-------

**SunStar Laboratories, Inc.**

**Volatile Organic Compounds by EPA Method 8260B**

cis-1,3-Dichloropropene	ND	0.0025	mg/kg	1	0100931	10/09/20	10/09/20	EPA 8260B	
trans-1,3-Dichloropropene	ND	0.0025	"	"	"	"	"	"	
Hexachlorobutadiene	ND	0.0025	"	"	"	"	"	"	
Isopropylbenzene	ND	0.0025	"	"	"	"	"	"	
p-Isopropyltoluene	ND	0.0025	"	"	"	"	"	"	
Methylene chloride	ND	0.010	"	"	"	"	"	"	
Naphthalene	ND	0.0025	"	"	"	"	"	"	
n-Propylbenzene	ND	0.0025	"	"	"	"	"	"	
Styrene	ND	0.0025	"	"	"	"	"	"	
1,1,2,2-Tetrachloroethane	ND	0.0025	"	"	"	"	"	"	
1,1,1,2-Tetrachloroethane	ND	0.0025	"	"	"	"	"	"	
Tetrachloroethene	ND	0.0025	"	"	"	"	"	"	
1,2,3-Trichlorobenzene	ND	0.0025	"	"	"	"	"	"	
1,2,4-Trichlorobenzene	ND	0.0025	"	"	"	"	"	"	
1,1,2-Trichloroethane	ND	0.0025	"	"	"	"	"	"	
1,1,1-Trichloroethane	ND	0.0025	"	"	"	"	"	"	
Trichloroethene	ND	0.0025	"	"	"	"	"	"	
Trichlorofluoromethane	ND	0.0025	"	"	"	"	"	"	
1,2,3-Trichloropropane	ND	0.0025	"	"	"	"	"	"	
1,3,5-Trimethylbenzene	ND	0.0025	"	"	"	"	"	"	
1,2,4-Trimethylbenzene	ND	0.0025	"	"	"	"	"	"	
Vinyl chloride	ND	0.0025	"	"	"	"	"	"	
Benzene	ND	0.0025	"	"	"	"	"	"	
Toluene	ND	0.0025	"	"	"	"	"	"	
Ethylbenzene	ND	0.0025	"	"	"	"	"	"	
m,p-Xylene	ND	0.0050	"	"	"	"	"	"	
o-Xylene	ND	0.0025	"	"	"	"	"	"	
Surrogate: 4-Bromofluorobenzene		99.1 %		75.4-139	"	"	"	"	
Surrogate: Dibromofluoromethane		95.2 %		73.1-125	"	"	"	"	
Surrogate: Toluene-d8		97.3 %		82.6-117	"	"	"	"	

SunStar Laboratories, Inc.



The results in this report apply to the samples analyzed in accordance with the chain of custody document. This analytical report must be reproduced in its entirety.

Jeff Lee, Project Manager



Terracon - Colton  
1355 East Cooley Dr.  
Colton CA, 92324

Project: WPT Property Fontana  
Project Number: CB207103A  
Project Manager: Todd McFarland

Reported:  
10/12/20 18:08

**SB-3-5**  
**T203530-05 (Soil)**

Analyte	Result	Reporting Limit	Units	Dilution	Batch	Prepared	Analyzed	Method	Notes
---------	--------	-----------------	-------	----------	-------	----------	----------	--------	-------

**SunStar Laboratories, Inc.**

**Extractable Petroleum Hydrocarbons by 8015B**

C6-C12 (GRO)	ND	10	mg/kg	1	0100905	10/09/20	10/10/20	EPA 8015B	
C13-C28 (DRO)	ND	10	"	"	"	"	"	"	
C29-C40 (MORO)	ND	10	"	"	"	"	"	"	
Surrogate: <i>p</i> -Terphenyl		65.9 %	65-135		"	"	"	"	

**Volatile Organic Compounds by EPA Method 8260B**

Bromobenzene	ND	0.0025	mg/kg	1	0100931	10/09/20	10/09/20	EPA 8260B	
Bromochloromethane	ND	0.0025	"	"	"	"	"	"	
Bromodichloromethane	ND	0.0025	"	"	"	"	"	"	
Bromoform	ND	0.0025	"	"	"	"	"	"	
Bromomethane	ND	0.0025	"	"	"	"	"	"	
n-Butylbenzene	ND	0.0025	"	"	"	"	"	"	
sec-Butylbenzene	ND	0.0025	"	"	"	"	"	"	
tert-Butylbenzene	ND	0.0025	"	"	"	"	"	"	
Carbon tetrachloride	ND	0.0025	"	"	"	"	"	"	
Chlorobenzene	ND	0.0025	"	"	"	"	"	"	
Chloroethane	ND	0.0025	"	"	"	"	"	"	
Chloroform	ND	0.0025	"	"	"	"	"	"	
Chloromethane	ND	0.0025	"	"	"	"	"	"	
2-Chlorotoluene	ND	0.0025	"	"	"	"	"	"	
4-Chlorotoluene	ND	0.0025	"	"	"	"	"	"	
Dibromochloromethane	ND	0.0025	"	"	"	"	"	"	
1,2-Dibromo-3-chloropropane	ND	0.0050	"	"	"	"	"	"	
1,2-Dibromoethane (EDB)	ND	0.0025	"	"	"	"	"	"	
Dibromomethane	ND	0.0025	"	"	"	"	"	"	
1,2-Dichlorobenzene	ND	0.0025	"	"	"	"	"	"	
1,3-Dichlorobenzene	ND	0.0025	"	"	"	"	"	"	
1,4-Dichlorobenzene	ND	0.0025	"	"	"	"	"	"	
Dichlorodifluoromethane	ND	0.0025	"	"	"	"	"	"	
1,1-Dichloroethane	ND	0.0025	"	"	"	"	"	"	
1,2-Dichloroethane	ND	0.0025	"	"	"	"	"	"	
1,1-Dichloroethene	ND	0.0025	"	"	"	"	"	"	

SunStar Laboratories, Inc.



The results in this report apply to the samples analyzed in accordance with the chain of custody document. This analytical report must be reproduced in its entirety.

Jeff Lee, Project Manager

Terracon - Colton  
 1355 East Cooley Dr.  
 Colton CA, 92324

Project: WPT Property Fontana  
 Project Number: CB207103A  
 Project Manager: Todd McFarland

Reported:  
 10/12/20 18:08

**SB-3-5**  
**T203530-05 (Soil)**

Analyte	Result	Reporting Limit	Units	Dilution	Batch	Prepared	Analyzed	Method	Notes
---------	--------	-----------------	-------	----------	-------	----------	----------	--------	-------

**SunStar Laboratories, Inc.**

**Volatile Organic Compounds by EPA Method 8260B**

Analyte	Result	Reporting Limit	Units	Dilution	Batch	Prepared	Analyzed	Method	Notes
cis-1,2-Dichloroethene	ND	0.0025	mg/kg	1	0100931	10/09/20	10/09/20	EPA 8260B	
trans-1,2-Dichloroethene	ND	0.0025	"	"	"	"	"	"	
1,2-Dichloropropane	ND	0.0025	"	"	"	"	"	"	
1,3-Dichloropropane	ND	0.0025	"	"	"	"	"	"	
2,2-Dichloropropane	ND	0.0025	"	"	"	"	"	"	
1,1-Dichloropropene	ND	0.0025	"	"	"	"	"	"	
cis-1,3-Dichloropropene	ND	0.0025	"	"	"	"	"	"	
trans-1,3-Dichloropropene	ND	0.0025	"	"	"	"	"	"	
Hexachlorobutadiene	ND	0.0025	"	"	"	"	"	"	
Isopropylbenzene	ND	0.0025	"	"	"	"	"	"	
p-Isopropyltoluene	ND	0.0025	"	"	"	"	"	"	
Methylene chloride	ND	0.010	"	"	"	"	"	"	
Naphthalene	ND	0.0025	"	"	"	"	"	"	
n-Propylbenzene	ND	0.0025	"	"	"	"	"	"	
Styrene	ND	0.0025	"	"	"	"	"	"	
1,1,2,2-Tetrachloroethane	ND	0.0025	"	"	"	"	"	"	
1,1,1,2-Tetrachloroethane	ND	0.0025	"	"	"	"	"	"	
Tetrachloroethene	ND	0.0025	"	"	"	"	"	"	
1,2,3-Trichlorobenzene	ND	0.0025	"	"	"	"	"	"	
1,2,4-Trichlorobenzene	ND	0.0025	"	"	"	"	"	"	
1,1,2-Trichloroethane	ND	0.0025	"	"	"	"	"	"	
1,1,1-Trichloroethane	ND	0.0025	"	"	"	"	"	"	
Trichloroethene	ND	0.0025	"	"	"	"	"	"	
Trichlorofluoromethane	ND	0.0025	"	"	"	"	"	"	
1,2,3-Trichloropropane	ND	0.0025	"	"	"	"	"	"	
1,3,5-Trimethylbenzene	ND	0.0025	"	"	"	"	"	"	
1,2,4-Trimethylbenzene	ND	0.0025	"	"	"	"	"	"	
Vinyl chloride	ND	0.0025	"	"	"	"	"	"	
Benzene	ND	0.0025	"	"	"	"	"	"	
Toluene	ND	0.0025	"	"	"	"	"	"	
Ethylbenzene	ND	0.0025	"	"	"	"	"	"	
m,p-Xylene	ND	0.0050	"	"	"	"	"	"	

SunStar Laboratories, Inc.



*The results in this report apply to the samples analyzed in accordance with the chain of custody document. This analytical report must be reproduced in its entirety.*

Jeff Lee, Project Manager

Terracon - Colton  
1355 East Cooley Dr.  
Colton CA, 92324

Project: WPT Property Fontana  
Project Number: CB207103A  
Project Manager: Todd McFarland

**Reported:**  
10/12/20 18:08

**SB-3-5**  
**T203530-05 (Soil)**

Analyte	Result	Reporting Limit	Units	Dilution	Batch	Prepared	Analyzed	Method	Notes
---------	--------	--------------------	-------	----------	-------	----------	----------	--------	-------

**SunStar Laboratories, Inc.**

**Volatile Organic Compounds by EPA Method 8260B**

Analyte	Result	Reporting Limit	Units	Dilution	Batch	Prepared	Analyzed	Method	Notes
o-Xylene	ND	0.0025	mg/kg	1	0100931	10/09/20	10/09/20	EPA 8260B	
Surrogate: 4-Bromofluorobenzene	99.6 %	75.4-139			"	"	"	"	
Surrogate: Dibromofluoromethane	93.3 %	73.1-125			"	"	"	"	
Surrogate: Toluene-d8	97.4 %	82.6-117			"	"	"	"	

SunStar Laboratories, Inc.



*The results in this report apply to the samples analyzed in accordance with the chain of custody document. This analytical report must be reproduced in its entirety.*

Jeff Lee, Project Manager

Terracon - Colton  
1355 East Cooley Dr.  
Colton CA, 92324

Project: WPT Property Fontana  
Project Number: CB207103A  
Project Manager: Todd McFarland

Reported:  
10/12/20 18:08

**SB-4-5**  
**T203530-06 (Soil)**

Analyte	Result	Reporting Limit	Units	Dilution	Batch	Prepared	Analyzed	Method	Notes
---------	--------	-----------------	-------	----------	-------	----------	----------	--------	-------

**SunStar Laboratories, Inc.**

**Extractable Petroleum Hydrocarbons by 8015B**

C6-C12 (GRO)	ND	10	mg/kg	1	0100905	10/09/20	10/10/20	EPA 8015B	
C13-C28 (DRO)	ND	10	"	"	"	"	"	"	
C29-C40 (MORO)	ND	10	"	"	"	"	"	"	
Surrogate: <i>p</i> -Terphenyl		84.1 %	65-135		"	"	"	"	

**Volatile Organic Compounds by EPA Method 8260B**

Bromobenzene	ND	0.0025	mg/kg	1	0100931	10/09/20	10/09/20	EPA 8260B	
Bromochloromethane	ND	0.0025	"	"	"	"	"	"	
Bromodichloromethane	ND	0.0025	"	"	"	"	"	"	
Bromoform	ND	0.0025	"	"	"	"	"	"	
Bromomethane	ND	0.0025	"	"	"	"	"	"	
n-Butylbenzene	ND	0.0025	"	"	"	"	"	"	
sec-Butylbenzene	ND	0.0025	"	"	"	"	"	"	
tert-Butylbenzene	ND	0.0025	"	"	"	"	"	"	
Carbon tetrachloride	ND	0.0025	"	"	"	"	"	"	
Chlorobenzene	ND	0.0025	"	"	"	"	"	"	
Chloroethane	ND	0.0025	"	"	"	"	"	"	
Chloroform	ND	0.0025	"	"	"	"	"	"	
Chloromethane	ND	0.0025	"	"	"	"	"	"	
2-Chlorotoluene	ND	0.0025	"	"	"	"	"	"	
4-Chlorotoluene	ND	0.0025	"	"	"	"	"	"	
Dibromochloromethane	ND	0.0025	"	"	"	"	"	"	
1,2-Dibromo-3-chloropropane	ND	0.0050	"	"	"	"	"	"	
1,2-Dibromoethane (EDB)	ND	0.0025	"	"	"	"	"	"	
Dibromomethane	ND	0.0025	"	"	"	"	"	"	
1,2-Dichlorobenzene	ND	0.0025	"	"	"	"	"	"	
1,3-Dichlorobenzene	ND	0.0025	"	"	"	"	"	"	
1,4-Dichlorobenzene	ND	0.0025	"	"	"	"	"	"	
Dichlorodifluoromethane	ND	0.0025	"	"	"	"	"	"	
1,1-Dichloroethane	ND	0.0025	"	"	"	"	"	"	
1,2-Dichloroethane	ND	0.0025	"	"	"	"	"	"	
1,1-Dichloroethene	ND	0.0025	"	"	"	"	"	"	

SunStar Laboratories, Inc.



Jeff Lee, Project Manager

*The results in this report apply to the samples analyzed in accordance with the chain of custody document. This analytical report must be reproduced in its entirety.*

Terracon - Colton  
1355 East Cooley Dr.  
Colton CA, 92324

Project: WPT Property Fontana  
Project Number: CB207103A  
Project Manager: Todd McFarland

Reported:  
10/12/20 18:08

**SB-4-5**  
**T203530-06 (Soil)**

Analyte	Result	Reporting Limit	Units	Dilution	Batch	Prepared	Analyzed	Method	Notes
---------	--------	-----------------	-------	----------	-------	----------	----------	--------	-------

**SunStar Laboratories, Inc.**

**Volatile Organic Compounds by EPA Method 8260B**

Analyte	Result	Reporting Limit	Units	Dilution	Batch	Prepared	Analyzed	Method	Notes
cis-1,2-Dichloroethene	ND	0.0025	mg/kg	1	0100931	10/09/20	10/09/20	EPA 8260B	
trans-1,2-Dichloroethene	ND	0.0025	"	"	"	"	"	"	
1,2-Dichloropropane	ND	0.0025	"	"	"	"	"	"	
1,3-Dichloropropane	ND	0.0025	"	"	"	"	"	"	
2,2-Dichloropropane	ND	0.0025	"	"	"	"	"	"	
1,1-Dichloropropene	ND	0.0025	"	"	"	"	"	"	
cis-1,3-Dichloropropene	ND	0.0025	"	"	"	"	"	"	
trans-1,3-Dichloropropene	ND	0.0025	"	"	"	"	"	"	
Hexachlorobutadiene	ND	0.0025	"	"	"	"	"	"	
Isopropylbenzene	ND	0.0025	"	"	"	"	"	"	
p-Isopropyltoluene	ND	0.0025	"	"	"	"	"	"	
Methylene chloride	ND	0.010	"	"	"	"	"	"	
Naphthalene	ND	0.0025	"	"	"	"	"	"	
n-Propylbenzene	ND	0.0025	"	"	"	"	"	"	
Styrene	ND	0.0025	"	"	"	"	"	"	
1,1,2,2-Tetrachloroethane	ND	0.0025	"	"	"	"	"	"	
1,1,1,2-Tetrachloroethane	ND	0.0025	"	"	"	"	"	"	
Tetrachloroethene	ND	0.0025	"	"	"	"	"	"	
1,2,3-Trichlorobenzene	ND	0.0025	"	"	"	"	"	"	
1,2,4-Trichlorobenzene	ND	0.0025	"	"	"	"	"	"	
1,1,2-Trichloroethane	ND	0.0025	"	"	"	"	"	"	
1,1,1-Trichloroethane	ND	0.0025	"	"	"	"	"	"	
Trichloroethene	ND	0.0025	"	"	"	"	"	"	
Trichlorofluoromethane	ND	0.0025	"	"	"	"	"	"	
1,2,3-Trichloropropane	ND	0.0025	"	"	"	"	"	"	
1,3,5-Trimethylbenzene	ND	0.0025	"	"	"	"	"	"	
1,2,4-Trimethylbenzene	ND	0.0025	"	"	"	"	"	"	
Vinyl chloride	ND	0.0025	"	"	"	"	"	"	
Benzene	ND	0.0025	"	"	"	"	"	"	
Toluene	ND	0.0025	"	"	"	"	"	"	
Ethylbenzene	ND	0.0025	"	"	"	"	"	"	
m,p-Xylene	ND	0.0050	"	"	"	"	"	"	

SunStar Laboratories, Inc.



*The results in this report apply to the samples analyzed in accordance with the chain of custody document. This analytical report must be reproduced in its entirety.*

Jeff Lee, Project Manager

Terracon - Colton  
1355 East Cooley Dr.  
Colton CA, 92324

Project: WPT Property Fontana  
Project Number: CB207103A  
Project Manager: Todd McFarland

**Reported:**  
10/12/20 18:08

**SB-4-5**  
**T203530-06 (Soil)**

Analyte	Result	Reporting Limit	Units	Dilution	Batch	Prepared	Analyzed	Method	Notes
---------	--------	--------------------	-------	----------	-------	----------	----------	--------	-------

**SunStar Laboratories, Inc.**

**Volatile Organic Compounds by EPA Method 8260B**

Analyte	Result	Reporting Limit	Units	Dilution	Batch	Prepared	Analyzed	Method	Notes
o-Xylene	ND	0.0025	mg/kg	1	0100931	10/09/20	10/09/20	EPA 8260B	
Surrogate: 4-Bromofluorobenzene		101 %	75.4-139		"	"	"	"	
Surrogate: Dibromofluoromethane		93.8 %	73.1-125		"	"	"	"	
Surrogate: Toluene-d8		97.3 %	82.6-117		"	"	"	"	

SunStar Laboratories, Inc.



*The results in this report apply to the samples analyzed in accordance with the chain of custody document. This analytical report must be reproduced in its entirety.*

Jeff Lee, Project Manager

Terracon - Colton  
1355 East Cooley Dr.  
Colton CA, 92324

Project: WPT Property Fontana  
Project Number: CB207103A  
Project Manager: Todd McFarland

Reported:  
10/12/20 18:08

**SB-5-5**  
**T203530-07 (Soil)**

Analyte	Result	Reporting Limit	Units	Dilution	Batch	Prepared	Analyzed	Method	Notes
---------	--------	-----------------	-------	----------	-------	----------	----------	--------	-------

**SunStar Laboratories, Inc.**

**Extractable Petroleum Hydrocarbons by 8015B**

C6-C12 (GRO)	ND	10	mg/kg	1	0100905	10/09/20	10/10/20	EPA 8015B	
C13-C28 (DRO)	ND	10	"	"	"	"	"	"	
C29-C40 (MORO)	ND	10	"	"	"	"	"	"	
Surrogate: <i>p</i> -Terphenyl		78.9 %		65-135	"	"	"	"	

**Volatile Organic Compounds by EPA Method 8260B**

Bromobenzene	ND	0.0025	mg/kg	1	0100931	10/09/20	10/09/20	EPA 8260B	
Bromochloromethane	ND	0.0025	"	"	"	"	"	"	
Bromodichloromethane	ND	0.0025	"	"	"	"	"	"	
Bromoform	ND	0.0025	"	"	"	"	"	"	
Bromomethane	ND	0.0025	"	"	"	"	"	"	
n-Butylbenzene	ND	0.0025	"	"	"	"	"	"	
sec-Butylbenzene	ND	0.0025	"	"	"	"	"	"	
tert-Butylbenzene	ND	0.0025	"	"	"	"	"	"	
Carbon tetrachloride	ND	0.0025	"	"	"	"	"	"	
Chlorobenzene	ND	0.0025	"	"	"	"	"	"	
Chloroethane	ND	0.0025	"	"	"	"	"	"	
Chloroform	ND	0.0025	"	"	"	"	"	"	
Chloromethane	ND	0.0025	"	"	"	"	"	"	
2-Chlorotoluene	ND	0.0025	"	"	"	"	"	"	
4-Chlorotoluene	ND	0.0025	"	"	"	"	"	"	
Dibromochloromethane	ND	0.0025	"	"	"	"	"	"	
1,2-Dibromo-3-chloropropane	ND	0.0050	"	"	"	"	"	"	
1,2-Dibromoethane (EDB)	ND	0.0025	"	"	"	"	"	"	
Dibromomethane	ND	0.0025	"	"	"	"	"	"	
1,2-Dichlorobenzene	ND	0.0025	"	"	"	"	"	"	
1,3-Dichlorobenzene	ND	0.0025	"	"	"	"	"	"	
1,4-Dichlorobenzene	ND	0.0025	"	"	"	"	"	"	
Dichlorodifluoromethane	ND	0.0025	"	"	"	"	"	"	
1,1-Dichloroethane	ND	0.0025	"	"	"	"	"	"	
1,2-Dichloroethane	ND	0.0025	"	"	"	"	"	"	
1,1-Dichloroethene	ND	0.0025	"	"	"	"	"	"	

SunStar Laboratories, Inc.



*The results in this report apply to the samples analyzed in accordance with the chain of custody document. This analytical report must be reproduced in its entirety.*

Jeff Lee, Project Manager

Terracon - Colton  
1355 East Cooley Dr.  
Colton CA, 92324

Project: WPT Property Fontana  
Project Number: CB207103A  
Project Manager: Todd McFarland

Reported:  
10/12/20 18:08

**SB-5-5**  
**T203530-07 (Soil)**

Analyte	Result	Reporting Limit	Units	Dilution	Batch	Prepared	Analyzed	Method	Notes
---------	--------	-----------------	-------	----------	-------	----------	----------	--------	-------

**SunStar Laboratories, Inc.**

**Volatile Organic Compounds by EPA Method 8260B**

Analyte	Result	Reporting Limit	Units	Dilution	Batch	Prepared	Analyzed	Method	Notes
cis-1,2-Dichloroethene	ND	0.0025	mg/kg	1	0100931	10/09/20	10/09/20	EPA 8260B	
trans-1,2-Dichloroethene	ND	0.0025	"	"	"	"	"	"	
1,2-Dichloropropane	ND	0.0025	"	"	"	"	"	"	
1,3-Dichloropropane	ND	0.0025	"	"	"	"	"	"	
2,2-Dichloropropane	ND	0.0025	"	"	"	"	"	"	
1,1-Dichloropropene	ND	0.0025	"	"	"	"	"	"	
cis-1,3-Dichloropropene	ND	0.0025	"	"	"	"	"	"	
trans-1,3-Dichloropropene	ND	0.0025	"	"	"	"	"	"	
Hexachlorobutadiene	ND	0.0025	"	"	"	"	"	"	
Isopropylbenzene	ND	0.0025	"	"	"	"	"	"	
p-Isopropyltoluene	ND	0.0025	"	"	"	"	"	"	
Methylene chloride	ND	0.010	"	"	"	"	"	"	
Naphthalene	ND	0.0025	"	"	"	"	"	"	
n-Propylbenzene	ND	0.0025	"	"	"	"	"	"	
Styrene	ND	0.0025	"	"	"	"	"	"	
1,1,2,2-Tetrachloroethane	ND	0.0025	"	"	"	"	"	"	
1,1,1,2-Tetrachloroethane	ND	0.0025	"	"	"	"	"	"	
Tetrachloroethene	ND	0.0025	"	"	"	"	"	"	
1,2,3-Trichlorobenzene	ND	0.0025	"	"	"	"	"	"	
1,2,4-Trichlorobenzene	ND	0.0025	"	"	"	"	"	"	
1,1,2-Trichloroethane	ND	0.0025	"	"	"	"	"	"	
1,1,1-Trichloroethane	ND	0.0025	"	"	"	"	"	"	
Trichloroethene	ND	0.0025	"	"	"	"	"	"	
Trichlorofluoromethane	ND	0.0025	"	"	"	"	"	"	
1,2,3-Trichloropropane	ND	0.0025	"	"	"	"	"	"	
1,3,5-Trimethylbenzene	ND	0.0025	"	"	"	"	"	"	
1,2,4-Trimethylbenzene	ND	0.0025	"	"	"	"	"	"	
Vinyl chloride	ND	0.0025	"	"	"	"	"	"	
Benzene	ND	0.0025	"	"	"	"	"	"	
Toluene	ND	0.0025	"	"	"	"	"	"	
Ethylbenzene	ND	0.0025	"	"	"	"	"	"	
m,p-Xylene	ND	0.0050	"	"	"	"	"	"	

SunStar Laboratories, Inc.



*The results in this report apply to the samples analyzed in accordance with the chain of custody document. This analytical report must be reproduced in its entirety.*

Jeff Lee, Project Manager



Terracon - Colton 1355 East Cooley Dr. Colton CA, 92324	Project: WPT Property Fontana Project Number: CB207103A Project Manager: Todd McFarland	<b>Reported:</b> 10/12/20 18:08
---	---	------------------------------------

**SB-5-5**  
**T203530-07 (Soil)**

Analyte	Result	Reporting Limit	Units	Dilution	Batch	Prepared	Analyzed	Method	Notes
---------	--------	-----------------	-------	----------	-------	----------	----------	--------	-------

**SunStar Laboratories, Inc.**

**Volatile Organic Compounds by EPA Method 8260B**

Analyte	Result	Reporting Limit	Units	Dilution	Batch	Prepared	Analyzed	Method
o-Xylene	ND	0.0025	mg/kg	1	0100931	10/09/20	10/09/20	EPA 8260B
Surrogate: 4-Bromofluorobenzene	101 %	75.4-139			"	"	"	"
Surrogate: Dibromofluoromethane	93.9 %	73.1-125			"	"	"	"
Surrogate: Toluene-d8	97.5 %	82.6-117			"	"	"	"

SunStar Laboratories, Inc.



*The results in this report apply to the samples analyzed in accordance with the chain of custody document. This analytical report must be reproduced in its entirety.*

Jeff Lee, Project Manager

Terracon - Colton  
1355 East Cooley Dr.  
Colton CA, 92324

Project: WPT Property Fontana  
Project Number: CB207103A  
Project Manager: Todd McFarland

**Reported:**  
10/12/20 18:08

**SB-6-3**  
**T203530-08 (Soil)**

Analyte	Result	Reporting Limit	Units	Dilution	Batch	Prepared	Analyzed	Method	Notes
---------	--------	-----------------	-------	----------	-------	----------	----------	--------	-------

**SunStar Laboratories, Inc.**

**Extractable Petroleum Hydrocarbons by 8015B**

C6-C12 (GRO)	ND	10	mg/kg	1	0100905	10/09/20	10/10/20	EPA 8015B	
<b>C13-C28 (DRO)</b>	<b>12</b>	10	"	"	"	"	"	"	
<b>C29-C40 (MORO)</b>	<b>63</b>	10	"	"	"	"	"	"	
<i>Surrogate: p-Terphenyl</i>		88.9 %		65-135	"	"	"	"	

**Metals by EPA 6010B**

Antimony	ND	3.0	mg/kg	1	0100833	10/08/20	10/12/20	EPA 6010b	
Silver	ND	2.0	"	"	"	"	"	"	
Arsenic	ND	5.0	"	"	"	"	"	"	
<b>Barium</b>	<b>27</b>	1.0	"	"	"	"	"	"	
Beryllium	ND	1.0	"	"	"	"	10/12/20	"	
Cadmium	ND	2.0	"	"	"	"	10/12/20	"	
<b>Chromium</b>	<b>7.7</b>	2.0	"	"	"	"	"	"	
<b>Cobalt</b>	<b>4.2</b>	2.0	"	"	"	"	"	"	
<b>Copper</b>	<b>4.9</b>	1.0	"	"	"	"	"	"	
Lead	ND	3.0	"	"	"	"	"	"	
Molybdenum	ND	5.0	"	"	"	"	"	"	
<b>Nickel</b>	<b>5.1</b>	2.0	"	"	"	"	"	"	
Selenium	ND	5.0	"	"	"	"	"	"	
Thallium	ND	5.0	"	"	"	"	"	"	
<b>Vanadium</b>	<b>16</b>	5.0	"	"	"	"	"	"	
<b>Zinc</b>	<b>23</b>	1.0	"	"	"	"	"	"	

**Cold Vapor Extraction EPA 7470/7471**

Mercury	ND	0.10	mg/kg	1	0100834	10/08/20	10/12/20	EPA 7471A Soil	
---------	----	------	-------	---	---------	----------	----------	-------------------	--

SunStar Laboratories, Inc.



*The results in this report apply to the samples analyzed in accordance with the chain of custody document. This analytical report must be reproduced in its entirety.*

Jeff Lee, Project Manager

Terracon - Colton  
1355 East Cooley Dr.  
Colton CA, 92324

Project: WPT Property Fontana  
Project Number: CB207103A  
Project Manager: Todd McFarland

Reported:  
10/12/20 18:08

**SB-6-3**  
**T203530-08 (Soil)**

Analyte	Result	Reporting Limit	Units	Dilution	Batch	Prepared	Analyzed	Method	Notes
---------	--------	-----------------	-------	----------	-------	----------	----------	--------	-------

**SunStar Laboratories, Inc.**

**Volatile Organic Compounds by EPA Method 8260B**

Analyte	Result	Reporting Limit	Units	Dilution	Batch	Prepared	Analyzed	Method
Bromobenzene	ND	0.0025	mg/kg	1	0100931	10/09/20	10/10/20	EPA 8260B
Bromochloromethane	ND	0.0025	"	"	"	"	"	"
Bromodichloromethane	ND	0.0025	"	"	"	"	"	"
Bromoform	ND	0.0025	"	"	"	"	"	"
Bromomethane	ND	0.0025	"	"	"	"	"	"
n-Butylbenzene	ND	0.0025	"	"	"	"	"	"
sec-Butylbenzene	ND	0.0025	"	"	"	"	"	"
tert-Butylbenzene	ND	0.0025	"	"	"	"	"	"
Carbon tetrachloride	ND	0.0025	"	"	"	"	"	"
Chlorobenzene	ND	0.0025	"	"	"	"	"	"
Chloroethane	ND	0.0025	"	"	"	"	"	"
Chloroform	ND	0.0025	"	"	"	"	"	"
Chloromethane	ND	0.0025	"	"	"	"	"	"
2-Chlorotoluene	ND	0.0025	"	"	"	"	"	"
4-Chlorotoluene	ND	0.0025	"	"	"	"	"	"
Dibromochloromethane	ND	0.0025	"	"	"	"	"	"
1,2-Dibromo-3-chloropropane	ND	0.0050	"	"	"	"	"	"
1,2-Dibromoethane (EDB)	ND	0.0025	"	"	"	"	"	"
Dibromomethane	ND	0.0025	"	"	"	"	"	"
1,2-Dichlorobenzene	ND	0.0025	"	"	"	"	"	"
1,3-Dichlorobenzene	ND	0.0025	"	"	"	"	"	"
1,4-Dichlorobenzene	ND	0.0025	"	"	"	"	"	"
Dichlorodifluoromethane	ND	0.0025	"	"	"	"	"	"
1,1-Dichloroethane	ND	0.0025	"	"	"	"	"	"
1,2-Dichloroethane	ND	0.0025	"	"	"	"	"	"
1,1-Dichloroethene	ND	0.0025	"	"	"	"	"	"
cis-1,2-Dichloroethene	ND	0.0025	"	"	"	"	"	"
trans-1,2-Dichloroethene	ND	0.0025	"	"	"	"	"	"
1,2-Dichloropropane	ND	0.0025	"	"	"	"	"	"
1,3-Dichloropropane	ND	0.0025	"	"	"	"	"	"
2,2-Dichloropropane	ND	0.0025	"	"	"	"	"	"
1,1-Dichloropropene	ND	0.0025	"	"	"	"	"	"

SunStar Laboratories, Inc.



Jeff Lee, Project Manager

*The results in this report apply to the samples analyzed in accordance with the chain of custody document. This analytical report must be reproduced in its entirety.*

Terracon - Colton  
 1355 East Cooley Dr.  
 Colton CA, 92324

Project: WPT Property Fontana  
 Project Number: CB207103A  
 Project Manager: Todd McFarland

Reported:  
 10/12/20 18:08

**SB-6-3**  
**T203530-08 (Soil)**

Analyte	Result	Reporting Limit	Units	Dilution	Batch	Prepared	Analyzed	Method	Notes
---------	--------	-----------------	-------	----------	-------	----------	----------	--------	-------

**SunStar Laboratories, Inc.**

**Volatile Organic Compounds by EPA Method 8260B**

cis-1,3-Dichloropropene	ND	0.0025	mg/kg	1	0100931	10/09/20	10/10/20	EPA 8260B	
trans-1,3-Dichloropropene	ND	0.0025	"	"	"	"	"	"	
Hexachlorobutadiene	ND	0.0025	"	"	"	"	"	"	
Isopropylbenzene	ND	0.0025	"	"	"	"	"	"	
p-Isopropyltoluene	ND	0.0025	"	"	"	"	"	"	
Methylene chloride	ND	0.010	"	"	"	"	"	"	
Naphthalene	ND	0.0025	"	"	"	"	"	"	
n-Propylbenzene	ND	0.0025	"	"	"	"	"	"	
Styrene	ND	0.0025	"	"	"	"	"	"	
1,1,2,2-Tetrachloroethane	ND	0.0025	"	"	"	"	"	"	
1,1,1,2-Tetrachloroethane	ND	0.0025	"	"	"	"	"	"	
Tetrachloroethene	ND	0.0025	"	"	"	"	"	"	
1,2,3-Trichlorobenzene	ND	0.0025	"	"	"	"	"	"	
1,2,4-Trichlorobenzene	ND	0.0025	"	"	"	"	"	"	
1,1,2-Trichloroethane	ND	0.0025	"	"	"	"	"	"	
1,1,1-Trichloroethane	ND	0.0025	"	"	"	"	"	"	
Trichloroethene	ND	0.0025	"	"	"	"	"	"	
Trichlorofluoromethane	ND	0.0025	"	"	"	"	"	"	
1,2,3-Trichloropropane	ND	0.0025	"	"	"	"	"	"	
1,3,5-Trimethylbenzene	ND	0.0025	"	"	"	"	"	"	
1,2,4-Trimethylbenzene	ND	0.0025	"	"	"	"	"	"	
Vinyl chloride	ND	0.0025	"	"	"	"	"	"	
Benzene	ND	0.0025	"	"	"	"	"	"	
Toluene	ND	0.0025	"	"	"	"	"	"	
<b>Ethylbenzene</b>	<b>0.0034</b>	0.0025	"	"	"	"	"	"	
<b>m,p-Xylene</b>	<b>0.023</b>	0.0050	"	"	"	"	"	"	
<b>o-Xylene</b>	<b>0.0097</b>	0.0025	"	"	"	"	"	"	
Surrogate: 4-Bromofluorobenzene		101 %	75.4-139		"	"	"	"	
Surrogate: Dibromofluoromethane		92.1 %	73.1-125		"	"	"	"	
Surrogate: Toluene-d8		97.3 %	82.6-117		"	"	"	"	

SunStar Laboratories, Inc.



The results in this report apply to the samples analyzed in accordance with the chain of custody document. This analytical report must be reproduced in its entirety.

Jeff Lee, Project Manager

Terracon - Colton  
1355 East Cooley Dr.  
Colton CA, 92324

Project: WPT Property Fontana  
Project Number: CB207103A  
Project Manager: Todd McFarland

Reported:  
10/12/20 18:08

**SB-6-5**  
**T203530-09 (Soil)**

Analyte	Result	Reporting Limit	Units	Dilution	Batch	Prepared	Analyzed	Method	Notes
---------	--------	-----------------	-------	----------	-------	----------	----------	--------	-------

**SunStar Laboratories, Inc.**

**Extractable Petroleum Hydrocarbons by 8015B**

C6-C12 (GRO)	ND	10	mg/kg	1	0100905	10/09/20	10/10/20	EPA 8015B	
<b>C13-C28 (DRO)</b>	<b>11</b>	10	"	"	"	"	"	"	
C29-C40 (MORO)	ND	10	"	"	"	"	"	"	
<i>Surrogate: p-Terphenyl</i>		80.7 %	65-135		"	"	"	"	

**Volatile Organic Compounds by EPA Method 8260B**

Bromobenzene	ND	0.0025	mg/kg	1	0100931	10/09/20	10/10/20	EPA 8260B	
Bromochloromethane	ND	0.0025	"	"	"	"	"	"	
Bromodichloromethane	ND	0.0025	"	"	"	"	"	"	
Bromoform	ND	0.0025	"	"	"	"	"	"	
Bromomethane	ND	0.0025	"	"	"	"	"	"	
n-Butylbenzene	ND	0.0025	"	"	"	"	"	"	
sec-Butylbenzene	ND	0.0025	"	"	"	"	"	"	
tert-Butylbenzene	ND	0.0025	"	"	"	"	"	"	
Carbon tetrachloride	ND	0.0025	"	"	"	"	"	"	
Chlorobenzene	ND	0.0025	"	"	"	"	"	"	
Chloroethane	ND	0.0025	"	"	"	"	"	"	
Chloroform	ND	0.0025	"	"	"	"	"	"	
Chloromethane	ND	0.0025	"	"	"	"	"	"	
2-Chlorotoluene	ND	0.0025	"	"	"	"	"	"	
4-Chlorotoluene	ND	0.0025	"	"	"	"	"	"	
Dibromochloromethane	ND	0.0025	"	"	"	"	"	"	
1,2-Dibromo-3-chloropropane	ND	0.0050	"	"	"	"	"	"	
1,2-Dibromoethane (EDB)	ND	0.0025	"	"	"	"	"	"	
Dibromomethane	ND	0.0025	"	"	"	"	"	"	
1,2-Dichlorobenzene	ND	0.0025	"	"	"	"	"	"	
1,3-Dichlorobenzene	ND	0.0025	"	"	"	"	"	"	
1,4-Dichlorobenzene	ND	0.0025	"	"	"	"	"	"	
Dichlorodifluoromethane	ND	0.0025	"	"	"	"	"	"	
1,1-Dichloroethane	ND	0.0025	"	"	"	"	"	"	
1,2-Dichloroethane	ND	0.0025	"	"	"	"	"	"	
1,1-Dichloroethene	ND	0.0025	"	"	"	"	"	"	

SunStar Laboratories, Inc.



Jeff Lee, Project Manager

*The results in this report apply to the samples analyzed in accordance with the chain of custody document. This analytical report must be reproduced in its entirety.*

Terracon - Colton  
1355 East Cooley Dr.  
Colton CA, 92324

Project: WPT Property Fontana  
Project Number: CB207103A  
Project Manager: Todd McFarland

Reported:  
10/12/20 18:08

**SB-6-5**  
**T203530-09 (Soil)**

Analyte	Result	Reporting Limit	Units	Dilution	Batch	Prepared	Analyzed	Method	Notes
---------	--------	-----------------	-------	----------	-------	----------	----------	--------	-------

**SunStar Laboratories, Inc.**

**Volatile Organic Compounds by EPA Method 8260B**

Analyte	Result	Reporting Limit	Units	Dilution	Batch	Prepared	Analyzed	Method	Notes
cis-1,2-Dichloroethene	ND	0.0025	mg/kg	1	0100931	10/09/20	10/10/20	EPA 8260B	
trans-1,2-Dichloroethene	ND	0.0025	"	"	"	"	"	"	
1,2-Dichloropropane	ND	0.0025	"	"	"	"	"	"	
1,3-Dichloropropane	ND	0.0025	"	"	"	"	"	"	
2,2-Dichloropropane	ND	0.0025	"	"	"	"	"	"	
1,1-Dichloropropene	ND	0.0025	"	"	"	"	"	"	
cis-1,3-Dichloropropene	ND	0.0025	"	"	"	"	"	"	
trans-1,3-Dichloropropene	ND	0.0025	"	"	"	"	"	"	
Hexachlorobutadiene	ND	0.0025	"	"	"	"	"	"	
Isopropylbenzene	ND	0.0025	"	"	"	"	"	"	
p-Isopropyltoluene	ND	0.0025	"	"	"	"	"	"	
Methylene chloride	ND	0.010	"	"	"	"	"	"	
Naphthalene	ND	0.0025	"	"	"	"	"	"	
n-Propylbenzene	ND	0.0025	"	"	"	"	"	"	
Styrene	ND	0.0025	"	"	"	"	"	"	
1,1,2,2-Tetrachloroethane	ND	0.0025	"	"	"	"	"	"	
1,1,1,2-Tetrachloroethane	ND	0.0025	"	"	"	"	"	"	
Tetrachloroethene	ND	0.0025	"	"	"	"	"	"	
1,2,3-Trichlorobenzene	ND	0.0025	"	"	"	"	"	"	
1,2,4-Trichlorobenzene	ND	0.0025	"	"	"	"	"	"	
1,1,2-Trichloroethane	ND	0.0025	"	"	"	"	"	"	
1,1,1-Trichloroethane	ND	0.0025	"	"	"	"	"	"	
Trichloroethene	ND	0.0025	"	"	"	"	"	"	
Trichlorofluoromethane	ND	0.0025	"	"	"	"	"	"	
1,2,3-Trichloropropane	ND	0.0025	"	"	"	"	"	"	
1,3,5-Trimethylbenzene	ND	0.0025	"	"	"	"	"	"	
1,2,4-Trimethylbenzene	ND	0.0025	"	"	"	"	"	"	
Vinyl chloride	ND	0.0025	"	"	"	"	"	"	
Benzene	ND	0.0025	"	"	"	"	"	"	
Toluene	ND	0.0025	"	"	"	"	"	"	
Ethylbenzene	ND	0.0025	"	"	"	"	"	"	
m,p-Xylene	ND	0.0050	"	"	"	"	"	"	

SunStar Laboratories, Inc.



*The results in this report apply to the samples analyzed in accordance with the chain of custody document. This analytical report must be reproduced in its entirety.*

Jeff Lee, Project Manager

Terracon - Colton  
1355 East Cooley Dr.  
Colton CA, 92324

Project: WPT Property Fontana  
Project Number: CB207103A  
Project Manager: Todd McFarland

**Reported:**  
10/12/20 18:08

**SB-6-5**  
**T203530-09 (Soil)**

Analyte	Result	Reporting Limit	Units	Dilution	Batch	Prepared	Analyzed	Method	Notes
---------	--------	--------------------	-------	----------	-------	----------	----------	--------	-------

**SunStar Laboratories, Inc.**

**Volatile Organic Compounds by EPA Method 8260B**

Analyte	Result	Reporting Limit	Units	Dilution	Batch	Prepared	Analyzed	Method	Notes
o-Xylene	ND	0.0025	mg/kg	1	0100931	10/09/20	10/10/20	EPA 8260B	
Surrogate: 4-Bromofluorobenzene		100 %	75.4-139		"	"	"	"	
Surrogate: Dibromofluoromethane		93.9 %	73.1-125		"	"	"	"	
Surrogate: Toluene-d8		97.1 %	82.6-117		"	"	"	"	

SunStar Laboratories, Inc.



*The results in this report apply to the samples analyzed in accordance with the chain of custody document. This analytical report must be reproduced in its entirety.*

Jeff Lee, Project Manager

Terracon - Colton  
1355 East Cooley Dr.  
Colton CA, 92324

Project: WPT Property Fontana  
Project Number: CB207103A  
Project Manager: Todd McFarland

Reported:  
10/12/20 18:08

**SB-7-5**  
**T203530-10 (Soil)**

Analyte	Result	Reporting Limit	Units	Dilution	Batch	Prepared	Analyzed	Method	Notes
---------	--------	-----------------	-------	----------	-------	----------	----------	--------	-------

**SunStar Laboratories, Inc.**

**Extractable Petroleum Hydrocarbons by 8015B**

C6-C12 (GRO)	ND	10	mg/kg	1	0100905	10/09/20	10/10/20	EPA 8015B	
C13-C28 (DRO)	ND	10	"	"	"	"	"	"	
C29-C40 (MORO)	ND	10	"	"	"	"	"	"	
Surrogate: <i>p</i> -Terphenyl		85.1 %	65-135		"	"	"	"	

**Volatile Organic Compounds by EPA Method 8260B**

Bromobenzene	ND	0.0025	mg/kg	1	0100931	10/09/20	10/10/20	EPA 8260B	
Bromochloromethane	ND	0.0025	"	"	"	"	"	"	
Bromodichloromethane	ND	0.0025	"	"	"	"	"	"	
Bromoform	ND	0.0025	"	"	"	"	"	"	
Bromomethane	ND	0.0025	"	"	"	"	"	"	
n-Butylbenzene	ND	0.0025	"	"	"	"	"	"	
sec-Butylbenzene	ND	0.0025	"	"	"	"	"	"	
tert-Butylbenzene	ND	0.0025	"	"	"	"	"	"	
Carbon tetrachloride	ND	0.0025	"	"	"	"	"	"	
Chlorobenzene	ND	0.0025	"	"	"	"	"	"	
Chloroethane	ND	0.0025	"	"	"	"	"	"	
Chloroform	ND	0.0025	"	"	"	"	"	"	
Chloromethane	ND	0.0025	"	"	"	"	"	"	
2-Chlorotoluene	ND	0.0025	"	"	"	"	"	"	
4-Chlorotoluene	ND	0.0025	"	"	"	"	"	"	
Dibromochloromethane	ND	0.0025	"	"	"	"	"	"	
1,2-Dibromo-3-chloropropane	ND	0.0050	"	"	"	"	"	"	
1,2-Dibromoethane (EDB)	ND	0.0025	"	"	"	"	"	"	
Dibromomethane	ND	0.0025	"	"	"	"	"	"	
1,2-Dichlorobenzene	ND	0.0025	"	"	"	"	"	"	
1,3-Dichlorobenzene	ND	0.0025	"	"	"	"	"	"	
1,4-Dichlorobenzene	ND	0.0025	"	"	"	"	"	"	
Dichlorodifluoromethane	ND	0.0025	"	"	"	"	"	"	
1,1-Dichloroethane	ND	0.0025	"	"	"	"	"	"	
1,2-Dichloroethane	ND	0.0025	"	"	"	"	"	"	
1,1-Dichloroethene	ND	0.0025	"	"	"	"	"	"	

SunStar Laboratories, Inc.



Jeff Lee, Project Manager

*The results in this report apply to the samples analyzed in accordance with the chain of custody document. This analytical report must be reproduced in its entirety.*



Terracon - Colton  
1355 East Cooley Dr.  
Colton CA, 92324

Project: WPT Property Fontana  
Project Number: CB207103A  
Project Manager: Todd McFarland

Reported:  
10/12/20 18:08

**SB-7-5**  
**T203530-10 (Soil)**

Analyte	Result	Reporting Limit	Units	Dilution	Batch	Prepared	Analyzed	Method	Notes
---------	--------	-----------------	-------	----------	-------	----------	----------	--------	-------

**SunStar Laboratories, Inc.**

**Volatile Organic Compounds by EPA Method 8260B**

Analyte	Result	Reporting Limit	Units	Dilution	Batch	Prepared	Analyzed	Method	Notes
cis-1,2-Dichloroethene	ND	0.0025	mg/kg	1	0100931	10/09/20	10/10/20	EPA 8260B	
trans-1,2-Dichloroethene	ND	0.0025	"	"	"	"	"	"	
1,2-Dichloropropane	ND	0.0025	"	"	"	"	"	"	
1,3-Dichloropropane	ND	0.0025	"	"	"	"	"	"	
2,2-Dichloropropane	ND	0.0025	"	"	"	"	"	"	
1,1-Dichloropropene	ND	0.0025	"	"	"	"	"	"	
cis-1,3-Dichloropropene	ND	0.0025	"	"	"	"	"	"	
trans-1,3-Dichloropropene	ND	0.0025	"	"	"	"	"	"	
Hexachlorobutadiene	ND	0.0025	"	"	"	"	"	"	
Isopropylbenzene	ND	0.0025	"	"	"	"	"	"	
p-Isopropyltoluene	ND	0.0025	"	"	"	"	"	"	
Methylene chloride	ND	0.010	"	"	"	"	"	"	
Naphthalene	ND	0.0025	"	"	"	"	"	"	
n-Propylbenzene	ND	0.0025	"	"	"	"	"	"	
Styrene	ND	0.0025	"	"	"	"	"	"	
1,1,2,2-Tetrachloroethane	ND	0.0025	"	"	"	"	"	"	
1,1,1,2-Tetrachloroethane	ND	0.0025	"	"	"	"	"	"	
Tetrachloroethene	ND	0.0025	"	"	"	"	"	"	
1,2,3-Trichlorobenzene	ND	0.0025	"	"	"	"	"	"	
1,2,4-Trichlorobenzene	ND	0.0025	"	"	"	"	"	"	
1,1,2-Trichloroethane	ND	0.0025	"	"	"	"	"	"	
1,1,1-Trichloroethane	ND	0.0025	"	"	"	"	"	"	
Trichloroethene	ND	0.0025	"	"	"	"	"	"	
Trichlorofluoromethane	ND	0.0025	"	"	"	"	"	"	
1,2,3-Trichloropropane	ND	0.0025	"	"	"	"	"	"	
1,3,5-Trimethylbenzene	ND	0.0025	"	"	"	"	"	"	
1,2,4-Trimethylbenzene	ND	0.0025	"	"	"	"	"	"	
Vinyl chloride	ND	0.0025	"	"	"	"	"	"	
Benzene	ND	0.0025	"	"	"	"	"	"	
Toluene	ND	0.0025	"	"	"	"	"	"	
Ethylbenzene	ND	0.0025	"	"	"	"	"	"	
m,p-Xylene	ND	0.0050	"	"	"	"	"	"	

SunStar Laboratories, Inc.



*The results in this report apply to the samples analyzed in accordance with the chain of custody document. This analytical report must be reproduced in its entirety.*

Jeff Lee, Project Manager

Terracon - Colton  
1355 East Cooley Dr.  
Colton CA, 92324

Project: WPT Property Fontana  
Project Number: CB207103A  
Project Manager: Todd McFarland

**Reported:**  
10/12/20 18:08

**SB-7-5**  
**T203530-10 (Soil)**

Analyte	Result	Reporting Limit	Units	Dilution	Batch	Prepared	Analyzed	Method	Notes
---------	--------	--------------------	-------	----------	-------	----------	----------	--------	-------

**SunStar Laboratories, Inc.**

**Volatile Organic Compounds by EPA Method 8260B**

Analyte	Result	Reporting Limit	Units	Dilution	Batch	Prepared	Analyzed	Method	Notes
o-Xylene	ND	0.0025	mg/kg	1	0100931	10/09/20	10/10/20	EPA 8260B	
Surrogate: 4-Bromofluorobenzene	99.7 %		75.4-139		"	"	"	"	
Surrogate: Dibromofluoromethane	92.0 %		73.1-125		"	"	"	"	
Surrogate: Toluene-d8	97.8 %		82.6-117		"	"	"	"	

SunStar Laboratories, Inc.



*The results in this report apply to the samples analyzed in accordance with the chain of custody document. This analytical report must be reproduced in its entirety.*

Jeff Lee, Project Manager

Terracon - Colton  
1355 East Cooley Dr.  
Colton CA, 92324

Project: WPT Property Fontana  
Project Number: CB207103A  
Project Manager: Todd McFarland

Reported:  
10/12/20 18:08

**SB-8-5**  
**T203530-11 (Soil)**

Analyte	Result	Reporting Limit	Units	Dilution	Batch	Prepared	Analyzed	Method	Notes
---------	--------	-----------------	-------	----------	-------	----------	----------	--------	-------

**SunStar Laboratories, Inc.**

**Extractable Petroleum Hydrocarbons by 8015B**

C6-C12 (GRO)	ND	10	mg/kg	1	0100905	10/09/20	10/11/20	EPA 8015B	
C13-C28 (DRO)	ND	10	"	"	"	"	"	"	
C29-C40 (MORO)	ND	10	"	"	"	"	"	"	
Surrogate: <i>p</i> -Terphenyl		80.2 %	65-135		"	"	"	"	

**Volatile Organic Compounds by EPA Method 8260B**

Bromobenzene	ND	0.0025	mg/kg	1	0100931	10/09/20	10/10/20	EPA 8260B	
Bromochloromethane	ND	0.0025	"	"	"	"	"	"	
Bromodichloromethane	ND	0.0025	"	"	"	"	"	"	
Bromoform	ND	0.0025	"	"	"	"	"	"	
Bromomethane	ND	0.0025	"	"	"	"	"	"	
n-Butylbenzene	ND	0.0025	"	"	"	"	"	"	
sec-Butylbenzene	ND	0.0025	"	"	"	"	"	"	
tert-Butylbenzene	ND	0.0025	"	"	"	"	"	"	
Carbon tetrachloride	ND	0.0025	"	"	"	"	"	"	
Chlorobenzene	ND	0.0025	"	"	"	"	"	"	
Chloroethane	ND	0.0025	"	"	"	"	"	"	
Chloroform	ND	0.0025	"	"	"	"	"	"	
Chloromethane	ND	0.0025	"	"	"	"	"	"	
2-Chlorotoluene	ND	0.0025	"	"	"	"	"	"	
4-Chlorotoluene	ND	0.0025	"	"	"	"	"	"	
Dibromochloromethane	ND	0.0025	"	"	"	"	"	"	
1,2-Dibromo-3-chloropropane	ND	0.0050	"	"	"	"	"	"	
1,2-Dibromoethane (EDB)	ND	0.0025	"	"	"	"	"	"	
Dibromomethane	ND	0.0025	"	"	"	"	"	"	
1,2-Dichlorobenzene	ND	0.0025	"	"	"	"	"	"	
1,3-Dichlorobenzene	ND	0.0025	"	"	"	"	"	"	
1,4-Dichlorobenzene	ND	0.0025	"	"	"	"	"	"	
Dichlorodifluoromethane	ND	0.0025	"	"	"	"	"	"	
1,1-Dichloroethane	ND	0.0025	"	"	"	"	"	"	
1,2-Dichloroethane	ND	0.0025	"	"	"	"	"	"	
1,1-Dichloroethene	ND	0.0025	"	"	"	"	"	"	

SunStar Laboratories, Inc.



Jeff Lee, Project Manager

*The results in this report apply to the samples analyzed in accordance with the chain of custody document. This analytical report must be reproduced in its entirety.*

Terracon - Colton  
1355 East Cooley Dr.  
Colton CA, 92324

Project: WPT Property Fontana  
Project Number: CB207103A  
Project Manager: Todd McFarland

Reported:  
10/12/20 18:08

**SB-8-5**  
**T203530-11 (Soil)**

Analyte	Result	Reporting Limit	Units	Dilution	Batch	Prepared	Analyzed	Method	Notes
---------	--------	-----------------	-------	----------	-------	----------	----------	--------	-------

**SunStar Laboratories, Inc.**

**Volatile Organic Compounds by EPA Method 8260B**

Analyte	Result	Reporting Limit	Units	Dilution	Batch	Prepared	Analyzed	Method	Notes
cis-1,2-Dichloroethene	ND	0.0025	mg/kg	1	0100931	10/09/20	10/10/20	EPA 8260B	
trans-1,2-Dichloroethene	ND	0.0025	"	"	"	"	"	"	
1,2-Dichloropropane	ND	0.0025	"	"	"	"	"	"	
1,3-Dichloropropane	ND	0.0025	"	"	"	"	"	"	
2,2-Dichloropropane	ND	0.0025	"	"	"	"	"	"	
1,1-Dichloropropene	ND	0.0025	"	"	"	"	"	"	
cis-1,3-Dichloropropene	ND	0.0025	"	"	"	"	"	"	
trans-1,3-Dichloropropene	ND	0.0025	"	"	"	"	"	"	
Hexachlorobutadiene	ND	0.0025	"	"	"	"	"	"	
Isopropylbenzene	ND	0.0025	"	"	"	"	"	"	
p-Isopropyltoluene	ND	0.0025	"	"	"	"	"	"	
Methylene chloride	ND	0.010	"	"	"	"	"	"	
Naphthalene	ND	0.0025	"	"	"	"	"	"	
n-Propylbenzene	ND	0.0025	"	"	"	"	"	"	
Styrene	ND	0.0025	"	"	"	"	"	"	
1,1,2,2-Tetrachloroethane	ND	0.0025	"	"	"	"	"	"	
1,1,1,2-Tetrachloroethane	ND	0.0025	"	"	"	"	"	"	
Tetrachloroethene	ND	0.0025	"	"	"	"	"	"	
1,2,3-Trichlorobenzene	ND	0.0025	"	"	"	"	"	"	
1,2,4-Trichlorobenzene	ND	0.0025	"	"	"	"	"	"	
1,1,2-Trichloroethane	ND	0.0025	"	"	"	"	"	"	
1,1,1-Trichloroethane	ND	0.0025	"	"	"	"	"	"	
Trichloroethene	ND	0.0025	"	"	"	"	"	"	
Trichlorofluoromethane	ND	0.0025	"	"	"	"	"	"	
1,2,3-Trichloropropane	ND	0.0025	"	"	"	"	"	"	
1,3,5-Trimethylbenzene	ND	0.0025	"	"	"	"	"	"	
1,2,4-Trimethylbenzene	ND	0.0025	"	"	"	"	"	"	
Vinyl chloride	ND	0.0025	"	"	"	"	"	"	
Benzene	ND	0.0025	"	"	"	"	"	"	
Toluene	ND	0.0025	"	"	"	"	"	"	
Ethylbenzene	ND	0.0025	"	"	"	"	"	"	
m,p-Xylene	ND	0.0050	"	"	"	"	"	"	

SunStar Laboratories, Inc.



The results in this report apply to the samples analyzed in accordance with the chain of custody document. This analytical report must be reproduced in its entirety.

Jeff Lee, Project Manager

Terracon - Colton  
1355 East Cooley Dr.  
Colton CA, 92324

Project: WPT Property Fontana  
Project Number: CB207103A  
Project Manager: Todd McFarland

**Reported:**  
10/12/20 18:08

**SB-8-5**  
**T203530-11 (Soil)**

Analyte	Result	Reporting Limit	Units	Dilution	Batch	Prepared	Analyzed	Method	Notes
---------	--------	--------------------	-------	----------	-------	----------	----------	--------	-------

**SunStar Laboratories, Inc.**

**Volatile Organic Compounds by EPA Method 8260B**

Analyte	Result	Reporting Limit	Units	Dilution	Batch	Prepared	Analyzed	Method	Notes
o-Xylene	ND	0.0025	mg/kg	1	0100931	10/09/20	10/10/20	EPA 8260B	
Surrogate: 4-Bromofluorobenzene	99.4 %	75.4-139			"	"	"	"	
Surrogate: Dibromofluoromethane	91.9 %	73.1-125			"	"	"	"	
Surrogate: Toluene-d8	97.6 %	82.6-117			"	"	"	"	

SunStar Laboratories, Inc.



*The results in this report apply to the samples analyzed in accordance with the chain of custody document. This analytical report must be reproduced in its entirety.*

Jeff Lee, Project Manager

Terracon - Colton  
1355 East Cooley Dr.  
Colton CA, 92324

Project: WPT Property Fontana  
Project Number: CB207103A  
Project Manager: Todd McFarland

Reported:  
10/12/20 18:08

**SB-9-5**  
**T203530-12 (Soil)**

Analyte	Result	Reporting Limit	Units	Dilution	Batch	Prepared	Analyzed	Method	Notes
---------	--------	-----------------	-------	----------	-------	----------	----------	--------	-------

**SunStar Laboratories, Inc.**

**Extractable Petroleum Hydrocarbons by 8015B**

C6-C12 (GRO)	ND	10	mg/kg	1	0100905	10/09/20	10/11/20	EPA 8015B	
C13-C28 (DRO)	ND	10	"	"	"	"	"	"	
C29-C40 (MORO)	ND	10	"	"	"	"	"	"	
Surrogate: <i>p</i> -Terphenyl		78.4 %		65-135	"	"	"	"	

**Volatile Organic Compounds by EPA Method 8260B**

Bromobenzene	ND	0.0025	mg/kg	1	0100931	10/09/20	10/10/20	EPA 8260B	
Bromochloromethane	ND	0.0025	"	"	"	"	"	"	
Bromodichloromethane	ND	0.0025	"	"	"	"	"	"	
Bromoform	ND	0.0025	"	"	"	"	"	"	
Bromomethane	ND	0.0025	"	"	"	"	"	"	
n-Butylbenzene	ND	0.0025	"	"	"	"	"	"	
sec-Butylbenzene	ND	0.0025	"	"	"	"	"	"	
tert-Butylbenzene	ND	0.0025	"	"	"	"	"	"	
Carbon tetrachloride	ND	0.0025	"	"	"	"	"	"	
Chlorobenzene	ND	0.0025	"	"	"	"	"	"	
Chloroethane	ND	0.0025	"	"	"	"	"	"	
Chloroform	ND	0.0025	"	"	"	"	"	"	
Chloromethane	ND	0.0025	"	"	"	"	"	"	
2-Chlorotoluene	ND	0.0025	"	"	"	"	"	"	
4-Chlorotoluene	ND	0.0025	"	"	"	"	"	"	
Dibromochloromethane	ND	0.0025	"	"	"	"	"	"	
1,2-Dibromo-3-chloropropane	ND	0.0050	"	"	"	"	"	"	
1,2-Dibromoethane (EDB)	ND	0.0025	"	"	"	"	"	"	
Dibromomethane	ND	0.0025	"	"	"	"	"	"	
1,2-Dichlorobenzene	ND	0.0025	"	"	"	"	"	"	
1,3-Dichlorobenzene	ND	0.0025	"	"	"	"	"	"	
1,4-Dichlorobenzene	ND	0.0025	"	"	"	"	"	"	
Dichlorodifluoromethane	ND	0.0025	"	"	"	"	"	"	
1,1-Dichloroethane	ND	0.0025	"	"	"	"	"	"	
1,2-Dichloroethane	ND	0.0025	"	"	"	"	"	"	
1,1-Dichloroethene	ND	0.0025	"	"	"	"	"	"	

SunStar Laboratories, Inc.



*The results in this report apply to the samples analyzed in accordance with the chain of custody document. This analytical report must be reproduced in its entirety.*

Jeff Lee, Project Manager

Terracon - Colton  
1355 East Cooley Dr.  
Colton CA, 92324

Project: WPT Property Fontana  
Project Number: CB207103A  
Project Manager: Todd McFarland

Reported:  
10/12/20 18:08

**SB-9-5**  
**T203530-12 (Soil)**

Analyte	Result	Reporting Limit	Units	Dilution	Batch	Prepared	Analyzed	Method	Notes
---------	--------	-----------------	-------	----------	-------	----------	----------	--------	-------

**SunStar Laboratories, Inc.**

**Volatile Organic Compounds by EPA Method 8260B**

Analyte	Result	Reporting Limit	Units	Dilution	Batch	Prepared	Analyzed	Method	Notes
cis-1,2-Dichloroethene	ND	0.0025	mg/kg	1	0100931	10/09/20	10/10/20	EPA 8260B	
trans-1,2-Dichloroethene	ND	0.0025	"	"	"	"	"	"	
1,2-Dichloropropane	ND	0.0025	"	"	"	"	"	"	
1,3-Dichloropropane	ND	0.0025	"	"	"	"	"	"	
2,2-Dichloropropane	ND	0.0025	"	"	"	"	"	"	
1,1-Dichloropropene	ND	0.0025	"	"	"	"	"	"	
cis-1,3-Dichloropropene	ND	0.0025	"	"	"	"	"	"	
trans-1,3-Dichloropropene	ND	0.0025	"	"	"	"	"	"	
Hexachlorobutadiene	ND	0.0025	"	"	"	"	"	"	
Isopropylbenzene	ND	0.0025	"	"	"	"	"	"	
p-Isopropyltoluene	ND	0.0025	"	"	"	"	"	"	
Methylene chloride	ND	0.010	"	"	"	"	"	"	
Naphthalene	ND	0.0025	"	"	"	"	"	"	
n-Propylbenzene	ND	0.0025	"	"	"	"	"	"	
Styrene	ND	0.0025	"	"	"	"	"	"	
1,1,2,2-Tetrachloroethane	ND	0.0025	"	"	"	"	"	"	
1,1,1,2-Tetrachloroethane	ND	0.0025	"	"	"	"	"	"	
Tetrachloroethene	ND	0.0025	"	"	"	"	"	"	
1,2,3-Trichlorobenzene	ND	0.0025	"	"	"	"	"	"	
1,2,4-Trichlorobenzene	ND	0.0025	"	"	"	"	"	"	
1,1,2-Trichloroethane	ND	0.0025	"	"	"	"	"	"	
1,1,1-Trichloroethane	ND	0.0025	"	"	"	"	"	"	
Trichloroethene	ND	0.0025	"	"	"	"	"	"	
Trichlorofluoromethane	ND	0.0025	"	"	"	"	"	"	
1,2,3-Trichloropropane	ND	0.0025	"	"	"	"	"	"	
1,3,5-Trimethylbenzene	ND	0.0025	"	"	"	"	"	"	
1,2,4-Trimethylbenzene	ND	0.0025	"	"	"	"	"	"	
Vinyl chloride	ND	0.0025	"	"	"	"	"	"	
Benzene	ND	0.0025	"	"	"	"	"	"	
Toluene	ND	0.0025	"	"	"	"	"	"	
Ethylbenzene	ND	0.0025	"	"	"	"	"	"	
m,p-Xylene	ND	0.0050	"	"	"	"	"	"	

SunStar Laboratories, Inc.



*The results in this report apply to the samples analyzed in accordance with the chain of custody document. This analytical report must be reproduced in its entirety.*

Jeff Lee, Project Manager

Terracon - Colton  
1355 East Cooley Dr.  
Colton CA, 92324

Project: WPT Property Fontana  
Project Number: CB207103A  
Project Manager: Todd McFarland

**Reported:**  
10/12/20 18:08

**SB-9-5**  
**T203530-12 (Soil)**

Analyte	Result	Reporting Limit	Units	Dilution	Batch	Prepared	Analyzed	Method	Notes
---------	--------	--------------------	-------	----------	-------	----------	----------	--------	-------

**SunStar Laboratories, Inc.**

**Volatile Organic Compounds by EPA Method 8260B**

Analyte	Result	Reporting Limit	Units	Dilution	Batch	Prepared	Analyzed	Method	Notes
o-Xylene	ND	0.0025	mg/kg	1	0100931	10/09/20	10/10/20	EPA 8260B	
Surrogate: 4-Bromofluorobenzene	102 %	75.4-139			"	"	"	"	
Surrogate: Dibromofluoromethane	95.5 %	73.1-125			"	"	"	"	
Surrogate: Toluene-d8	96.6 %	82.6-117			"	"	"	"	

SunStar Laboratories, Inc.



*The results in this report apply to the samples analyzed in accordance with the chain of custody document. This analytical report must be reproduced in its entirety.*

Jeff Lee, Project Manager



Terracon - Colton  
1355 East Cooley Dr.  
Colton CA, 92324

Project: WPT Property Fontana  
Project Number: CB207103A  
Project Manager: Todd McFarland

Reported:  
10/12/20 18:08

**SB-10-5**  
**T203530-13 (Soil)**

Analyte	Result	Reporting Limit	Units	Dilution	Batch	Prepared	Analyzed	Method	Notes
---------	--------	-----------------	-------	----------	-------	----------	----------	--------	-------

**SunStar Laboratories, Inc.**

**Extractable Petroleum Hydrocarbons by 8015B**

C6-C12 (GRO)	ND	10	mg/kg	1	0100905	10/09/20	10/11/20	EPA 8015B	
C13-C28 (DRO)	ND	10	"	"	"	"	"	"	
C29-C40 (MORO)	ND	10	"	"	"	"	"	"	
Surrogate: <i>p</i> -Terphenyl		83.1 %	65-135		"	"	"	"	

**Volatile Organic Compounds by EPA Method 8260B**

Bromobenzene	ND	0.0025	mg/kg	1	0100931	10/09/20	10/10/20	EPA 8260B	
Bromochloromethane	ND	0.0025	"	"	"	"	"	"	
Bromodichloromethane	ND	0.0025	"	"	"	"	"	"	
Bromoform	ND	0.0025	"	"	"	"	"	"	
Bromomethane	ND	0.0025	"	"	"	"	"	"	
n-Butylbenzene	ND	0.0025	"	"	"	"	"	"	
sec-Butylbenzene	ND	0.0025	"	"	"	"	"	"	
tert-Butylbenzene	ND	0.0025	"	"	"	"	"	"	
Carbon tetrachloride	ND	0.0025	"	"	"	"	"	"	
Chlorobenzene	ND	0.0025	"	"	"	"	"	"	
Chloroethane	ND	0.0025	"	"	"	"	"	"	
Chloroform	ND	0.0025	"	"	"	"	"	"	
Chloromethane	ND	0.0025	"	"	"	"	"	"	
2-Chlorotoluene	ND	0.0025	"	"	"	"	"	"	
4-Chlorotoluene	ND	0.0025	"	"	"	"	"	"	
Dibromochloromethane	ND	0.0025	"	"	"	"	"	"	
1,2-Dibromo-3-chloropropane	ND	0.0050	"	"	"	"	"	"	
1,2-Dibromoethane (EDB)	ND	0.0025	"	"	"	"	"	"	
Dibromomethane	ND	0.0025	"	"	"	"	"	"	
1,2-Dichlorobenzene	ND	0.0025	"	"	"	"	"	"	
1,3-Dichlorobenzene	ND	0.0025	"	"	"	"	"	"	
1,4-Dichlorobenzene	ND	0.0025	"	"	"	"	"	"	
Dichlorodifluoromethane	ND	0.0025	"	"	"	"	"	"	
1,1-Dichloroethane	ND	0.0025	"	"	"	"	"	"	
1,2-Dichloroethane	ND	0.0025	"	"	"	"	"	"	
1,1-Dichloroethene	ND	0.0025	"	"	"	"	"	"	

SunStar Laboratories, Inc.



The results in this report apply to the samples analyzed in accordance with the chain of custody document. This analytical report must be reproduced in its entirety.

Jeff Lee, Project Manager

Terracon - Colton  
1355 East Cooley Dr.  
Colton CA, 92324

Project: WPT Property Fontana  
Project Number: CB207103A  
Project Manager: Todd McFarland

Reported:  
10/12/20 18:08

**SB-10-5**  
**T203530-13 (Soil)**

Analyte	Result	Reporting Limit	Units	Dilution	Batch	Prepared	Analyzed	Method	Notes
---------	--------	-----------------	-------	----------	-------	----------	----------	--------	-------

**SunStar Laboratories, Inc.**

**Volatile Organic Compounds by EPA Method 8260B**

Analyte	Result	Reporting Limit	Units	Dilution	Batch	Prepared	Analyzed	Method	Notes
cis-1,2-Dichloroethene	ND	0.0025	mg/kg	1	0100931	10/09/20	10/10/20	EPA 8260B	
trans-1,2-Dichloroethene	ND	0.0025	"	"	"	"	"	"	
1,2-Dichloropropane	ND	0.0025	"	"	"	"	"	"	
1,3-Dichloropropane	ND	0.0025	"	"	"	"	"	"	
2,2-Dichloropropane	ND	0.0025	"	"	"	"	"	"	
1,1-Dichloropropene	ND	0.0025	"	"	"	"	"	"	
cis-1,3-Dichloropropene	ND	0.0025	"	"	"	"	"	"	
trans-1,3-Dichloropropene	ND	0.0025	"	"	"	"	"	"	
Hexachlorobutadiene	ND	0.0025	"	"	"	"	"	"	
Isopropylbenzene	ND	0.0025	"	"	"	"	"	"	
p-Isopropyltoluene	ND	0.0025	"	"	"	"	"	"	
Methylene chloride	ND	0.010	"	"	"	"	"	"	
Naphthalene	ND	0.0025	"	"	"	"	"	"	
n-Propylbenzene	ND	0.0025	"	"	"	"	"	"	
Styrene	ND	0.0025	"	"	"	"	"	"	
1,1,2,2-Tetrachloroethane	ND	0.0025	"	"	"	"	"	"	
1,1,1,2-Tetrachloroethane	ND	0.0025	"	"	"	"	"	"	
Tetrachloroethene	ND	0.0025	"	"	"	"	"	"	
1,2,3-Trichlorobenzene	ND	0.0025	"	"	"	"	"	"	
1,2,4-Trichlorobenzene	ND	0.0025	"	"	"	"	"	"	
1,1,2-Trichloroethane	ND	0.0025	"	"	"	"	"	"	
1,1,1-Trichloroethane	ND	0.0025	"	"	"	"	"	"	
Trichloroethene	ND	0.0025	"	"	"	"	"	"	
Trichlorofluoromethane	ND	0.0025	"	"	"	"	"	"	
1,2,3-Trichloropropane	ND	0.0025	"	"	"	"	"	"	
1,3,5-Trimethylbenzene	ND	0.0025	"	"	"	"	"	"	
1,2,4-Trimethylbenzene	ND	0.0025	"	"	"	"	"	"	
Vinyl chloride	ND	0.0025	"	"	"	"	"	"	
Benzene	ND	0.0025	"	"	"	"	"	"	
Toluene	ND	0.0025	"	"	"	"	"	"	
Ethylbenzene	ND	0.0025	"	"	"	"	"	"	
m,p-Xylene	ND	0.0050	"	"	"	"	"	"	

SunStar Laboratories, Inc.



The results in this report apply to the samples analyzed in accordance with the chain of custody document. This analytical report must be reproduced in its entirety.

Jeff Lee, Project Manager

Terracon - Colton  
1355 East Cooley Dr.  
Colton CA, 92324

Project: WPT Property Fontana  
Project Number: CB207103A  
Project Manager: Todd McFarland

**Reported:**  
10/12/20 18:08

**SB-10-5**  
**T203530-13 (Soil)**

Analyte	Result	Reporting Limit	Units	Dilution	Batch	Prepared	Analyzed	Method	Notes
---------	--------	--------------------	-------	----------	-------	----------	----------	--------	-------

**SunStar Laboratories, Inc.**

**Volatile Organic Compounds by EPA Method 8260B**

Analyte	Result	Reporting Limit	Units	Dilution	Batch	Prepared	Analyzed	Method	Notes
o-Xylene	ND	0.0025	mg/kg	1	0100931	10/09/20	10/10/20	EPA 8260B	
Surrogate: 4-Bromofluorobenzene	99.5 %	75.4-139			"	"	"	"	
Surrogate: Dibromofluoromethane	90.9 %	73.1-125			"	"	"	"	
Surrogate: Toluene-d8	97.0 %	82.6-117			"	"	"	"	

SunStar Laboratories, Inc.



*The results in this report apply to the samples analyzed in accordance with the chain of custody document. This analytical report must be reproduced in its entirety.*

Jeff Lee, Project Manager

Terracon - Colton  
1355 East Cooley Dr.  
Colton CA, 92324

Project: WPT Property Fontana  
Project Number: CB207103A  
Project Manager: Todd McFarland

Reported:  
10/12/20 18:08

**SB-11-5**  
**T203530-14 (Soil)**

Analyte	Result	Reporting Limit	Units	Dilution	Batch	Prepared	Analyzed	Method	Notes
---------	--------	-----------------	-------	----------	-------	----------	----------	--------	-------

**SunStar Laboratories, Inc.**

**Extractable Petroleum Hydrocarbons by 8015B**

C6-C12 (GRO)	ND	10	mg/kg	1	0100905	10/09/20	10/11/20	EPA 8015B	
C13-C28 (DRO)	ND	10	"	"	"	"	"	"	
C29-C40 (MORO)	ND	10	"	"	"	"	"	"	
Surrogate: <i>p</i> -Terphenyl		81.6 %	65-135		"	"	"	"	

**Volatile Organic Compounds by EPA Method 8260B**

Bromobenzene	ND	0.0025	mg/kg	1	0100931	10/09/20	10/10/20	EPA 8260B	
Bromochloromethane	ND	0.0025	"	"	"	"	"	"	
Bromodichloromethane	ND	0.0025	"	"	"	"	"	"	
Bromoform	ND	0.0025	"	"	"	"	"	"	
Bromomethane	ND	0.0025	"	"	"	"	"	"	
n-Butylbenzene	ND	0.0025	"	"	"	"	"	"	
sec-Butylbenzene	ND	0.0025	"	"	"	"	"	"	
tert-Butylbenzene	ND	0.0025	"	"	"	"	"	"	
Carbon tetrachloride	ND	0.0025	"	"	"	"	"	"	
Chlorobenzene	ND	0.0025	"	"	"	"	"	"	
Chloroethane	ND	0.0025	"	"	"	"	"	"	
Chloroform	ND	0.0025	"	"	"	"	"	"	
Chloromethane	ND	0.0025	"	"	"	"	"	"	
2-Chlorotoluene	ND	0.0025	"	"	"	"	"	"	
4-Chlorotoluene	ND	0.0025	"	"	"	"	"	"	
Dibromochloromethane	ND	0.0025	"	"	"	"	"	"	
1,2-Dibromo-3-chloropropane	ND	0.0050	"	"	"	"	"	"	
1,2-Dibromoethane (EDB)	ND	0.0025	"	"	"	"	"	"	
Dibromomethane	ND	0.0025	"	"	"	"	"	"	
1,2-Dichlorobenzene	ND	0.0025	"	"	"	"	"	"	
1,3-Dichlorobenzene	ND	0.0025	"	"	"	"	"	"	
1,4-Dichlorobenzene	ND	0.0025	"	"	"	"	"	"	
Dichlorodifluoromethane	ND	0.0025	"	"	"	"	"	"	
1,1-Dichloroethane	ND	0.0025	"	"	"	"	"	"	
1,2-Dichloroethane	ND	0.0025	"	"	"	"	"	"	
1,1-Dichloroethene	ND	0.0025	"	"	"	"	"	"	

SunStar Laboratories, Inc.



The results in this report apply to the samples analyzed in accordance with the chain of custody document. This analytical report must be reproduced in its entirety.

Jeff Lee, Project Manager

Terracon - Colton  
 1355 East Cooley Dr.  
 Colton CA, 92324

Project: WPT Property Fontana  
 Project Number: CB207103A  
 Project Manager: Todd McFarland

Reported:  
 10/12/20 18:08

**SB-11-5**  
**T203530-14 (Soil)**

Analyte	Result	Reporting Limit	Units	Dilution	Batch	Prepared	Analyzed	Method	Notes
---------	--------	-----------------	-------	----------	-------	----------	----------	--------	-------

**SunStar Laboratories, Inc.**

**Volatile Organic Compounds by EPA Method 8260B**

Analyte	Result	Reporting Limit	Units	Dilution	Batch	Prepared	Analyzed	Method
cis-1,2-Dichloroethene	ND	0.0025	mg/kg	1	0100931	10/09/20	10/10/20	EPA 8260B
trans-1,2-Dichloroethene	ND	0.0025	"	"	"	"	"	"
1,2-Dichloropropane	ND	0.0025	"	"	"	"	"	"
1,3-Dichloropropane	ND	0.0025	"	"	"	"	"	"
2,2-Dichloropropane	ND	0.0025	"	"	"	"	"	"
1,1-Dichloropropene	ND	0.0025	"	"	"	"	"	"
cis-1,3-Dichloropropene	ND	0.0025	"	"	"	"	"	"
trans-1,3-Dichloropropene	ND	0.0025	"	"	"	"	"	"
Hexachlorobutadiene	ND	0.0025	"	"	"	"	"	"
Isopropylbenzene	ND	0.0025	"	"	"	"	"	"
p-Isopropyltoluene	ND	0.0025	"	"	"	"	"	"
Methylene chloride	ND	0.010	"	"	"	"	"	"
Naphthalene	ND	0.0025	"	"	"	"	"	"
n-Propylbenzene	ND	0.0025	"	"	"	"	"	"
Styrene	ND	0.0025	"	"	"	"	"	"
1,1,2,2-Tetrachloroethane	ND	0.0025	"	"	"	"	"	"
1,1,1,2-Tetrachloroethane	ND	0.0025	"	"	"	"	"	"
Tetrachloroethene	ND	0.0025	"	"	"	"	"	"
1,2,3-Trichlorobenzene	ND	0.0025	"	"	"	"	"	"
1,2,4-Trichlorobenzene	ND	0.0025	"	"	"	"	"	"
1,1,2-Trichloroethane	ND	0.0025	"	"	"	"	"	"
1,1,1-Trichloroethane	ND	0.0025	"	"	"	"	"	"
Trichloroethene	ND	0.0025	"	"	"	"	"	"
Trichlorofluoromethane	ND	0.0025	"	"	"	"	"	"
1,2,3-Trichloropropane	ND	0.0025	"	"	"	"	"	"
1,3,5-Trimethylbenzene	ND	0.0025	"	"	"	"	"	"
1,2,4-Trimethylbenzene	ND	0.0025	"	"	"	"	"	"
Vinyl chloride	ND	0.0025	"	"	"	"	"	"
Benzene	ND	0.0025	"	"	"	"	"	"
Toluene	ND	0.0025	"	"	"	"	"	"
Ethylbenzene	ND	0.0025	"	"	"	"	"	"
m,p-Xylene	ND	0.0050	"	"	"	"	"	"

SunStar Laboratories, Inc.



*The results in this report apply to the samples analyzed in accordance with the chain of custody document. This analytical report must be reproduced in its entirety.*

Jeff Lee, Project Manager



25712 Commercentre Drive  
 Lake Forest, California 92630  
 949.297.5020 Phone  
 949.297.5027 Fax

Terracon - Colton 1355 East Cooley Dr. Colton CA, 92324	Project: WPT Property Fontana Project Number: CB207103A Project Manager: Todd McFarland	Reported: 10/12/20 18:08
---	---	-----------------------------

**SB-11-5**  
**T203530-14 (Soil)**

Analyte	Result	Reporting Limit	Units	Dilution	Batch	Prepared	Analyzed	Method	Notes
---------	--------	-----------------	-------	----------	-------	----------	----------	--------	-------

**SunStar Laboratories, Inc.**

**Volatile Organic Compounds by EPA Method 8260B**

Analyte	Result	Reporting Limit	Units	Dilution	Batch	Prepared	Analyzed	Method
o-Xylene	ND	0.0025	mg/kg	1	0100931	10/09/20	10/10/20	EPA 8260B
Surrogate: 4-Bromofluorobenzene	100 %	75.4-139			"	"	"	"
Surrogate: Dibromofluoromethane	92.0 %	73.1-125			"	"	"	"
Surrogate: Toluene-d8	97.1 %	82.6-117			"	"	"	"

SunStar Laboratories, Inc.

*The results in this report apply to the samples analyzed in accordance with the chain of custody document. This analytical report must be reproduced in its entirety.*

Jeff Lee, Project Manager



Terracon - Colton  
1355 East Cooley Dr.  
Colton CA, 92324

Project: WPT Property Fontana  
Project Number: CB207103A  
Project Manager: Todd McFarland

Reported:  
10/12/20 18:08

**Metals by EPA 6010B - Quality Control**

**SunStar Laboratories, Inc.**

Analyte	Result	Reporting Limit	Units	Spike Level	Source Result	%REC	%REC Limits	RPD	RPD Limit	Notes
---------	--------	-----------------	-------	-------------	---------------	------	-------------	-----	-----------	-------

**Batch 0100833 - EPA 3050B**

**Blank (0100833-BLK1)**

Prepared: 10/08/20 Analyzed: 10/12/20

Antimony	ND	3.0	mg/kg							
Silver	ND	2.0	"							
Arsenic	ND	5.0	"							
Barium	ND	1.0	"							
Beryllium	ND	1.0	"							
Cadmium	ND	2.0	"							
Chromium	ND	2.0	"							
Cobalt	ND	2.0	"							
Copper	ND	1.0	"							
Lead	ND	3.0	"							
Molybdenum	ND	5.0	"							
Nickel	ND	2.0	"							
Selenium	ND	5.0	"							
Thallium	ND	5.0	"							
Vanadium	ND	5.0	"							
Zinc	ND	1.0	"							

**LCS (0100833-BS1)**

Prepared: 10/08/20 Analyzed: 10/12/20

Arsenic	95.9	5.0	mg/kg	100		95.9	75-125			
Barium	96.6	1.0	"	100		96.6	75-125			
Cadmium	96.0	2.0	"	100		96.0	75-125			
Chromium	96.5	2.0	"	100		96.5	75-125			
Lead	95.5	3.0	"	100		95.5	75-125			

**Matrix Spike (0100833-MS1)**

Source: T203522-03

Prepared: 10/08/20 Analyzed: 10/12/20

Arsenic	76.3	25	mg/kg	98.0	4.83	72.9	75-125			QM-05
Barium	160	5.0	"	98.0	54.7	107	75-125			
Cadmium	75.8	10	"	98.0	1.09	76.2	75-125			
Chromium	98.7	10	"	98.0	21.5	78.8	75-125			
Lead	73.8	15	"	98.0	ND	75.3	75-125			

SunStar Laboratories, Inc.



Jeff Lee, Project Manager

The results in this report apply to the samples analyzed in accordance with the chain of custody document. This analytical report must be reproduced in its entirety.





25712 Commercentre Drive  
 Lake Forest, California 92630  
 949.297.5020 Phone  
 949.297.5027 Fax

Terracon - Colton 1355 East Cooley Dr. Colton CA, 92324	Project: WPT Property Fontana Project Number: CB207103A Project Manager: Todd McFarland	Reported: 10/12/20 18:08
---	---	-----------------------------

**Metals by EPA 6010B - Quality Control**

**SunStar Laboratories, Inc.**

Analyte	Result	Reporting Limit	Units	Spike Level	Source Result	%REC	%REC Limits	RPD	RPD Limit	Notes
---------	--------	-----------------	-------	-------------	---------------	------	-------------	-----	-----------	-------

**Batch 0100833 - EPA 3050B**

**Matrix Spike Dup (0100833-MSD1)**

**Source: T203522-03**

Prepared: 10/08/20 Analyzed: 10/12/20

Arsenic	72.6	25	mg/kg	98.0	4.83	69.1	75-125	4.91	20	QM-05
Barium	123	5.0	"	98.0	54.7	70.0	75-125	25.7	20	QM-05
Cadmium	71.8	10	"	98.0	1.09	72.1	75-125	5.45	20	QM-05
Chromium	94.3	10	"	98.0	21.5	74.3	75-125	4.57	20	QM-05
Lead	70.6	15	"	98.0	ND	72.0	75-125	4.43	20	QM-05

SunStar Laboratories, Inc.

*The results in this report apply to the samples analyzed in accordance with the chain of custody document. This analytical report must be reproduced in its entirety.*

Jeff Lee, Project Manager

Terracon - Colton  
1355 East Cooley Dr.  
Colton CA, 92324

Project: WPT Property Fontana  
Project Number: CB207103A  
Project Manager: Todd McFarland

**Reported:**  
10/12/20 18:08

**Cold Vapor Extraction EPA 7470/7471 - Quality Control**

**SunStar Laboratories, Inc.**

Analyte	Result	Reporting Limit	Units	Spike Level	Source Result	%REC	%REC Limits	RPD	RPD Limit	Notes
---------	--------	-----------------	-------	-------------	---------------	------	-------------	-----	-----------	-------

**Batch 0100834 - EPA 7471A Soil**

**Blank (0100834-BLK1)**

Prepared: 10/08/20 Analyzed: 10/12/20

Mercury	ND	0.10	mg/kg							
---------	----	------	-------	--	--	--	--	--	--	--

**LCS (0100834-BS1)**

Prepared: 10/08/20 Analyzed: 10/12/20

Mercury	0.407	0.10	mg/kg	0.410		99.3	80-120			
---------	-------	------	-------	-------	--	------	--------	--	--	--

**Matrix Spike (0100834-MS1)**

**Source: T203512-01**

Prepared: 10/08/20 Analyzed: 10/12/20

Mercury	0.429	0.10	mg/kg	0.417	ND	103	75-125			
---------	-------	------	-------	-------	----	-----	--------	--	--	--

**Matrix Spike Dup (0100834-MSD1)**

**Source: T203512-01**

Prepared: 10/08/20 Analyzed: 10/12/20

Mercury	0.426	0.10	mg/kg	0.417	ND	102	75-125	0.680	20	
---------	-------	------	-------	-------	----	-----	--------	-------	----	--

SunStar Laboratories, Inc.



*The results in this report apply to the samples analyzed in accordance with the chain of custody document. This analytical report must be reproduced in its entirety.*

Jeff Lee, Project Manager



25712 Commercentre Drive  
 Lake Forest, California 92630  
 949.297.5020 Phone  
 949.297.5027 Fax

Terracon - Colton 1355 East Cooley Dr. Colton CA, 92324	Project: WPT Property Fontana Project Number: CB207103A Project Manager: Todd McFarland	Reported: 10/12/20 18:08
---	---	-----------------------------

**Volatile Organic Compounds by EPA Method 8260B - Quality Control**

**SunStar Laboratories, Inc.**

Analyte	Result	Reporting Limit	Units	Spike Level	Source Result	%REC	%REC Limits	RPD	RPD Limit	Notes
---------	--------	-----------------	-------	-------------	---------------	------	-------------	-----	-----------	-------

**Batch 0100931 - EPA 5030 GCMS**

Blank (0100931-BLK1)	Prepared & Analyzed: 10/09/20									AO-1
Bromobenzene	ND	0.0025	mg/kg							
Bromochloromethane	ND	0.0025	"							
Bromodichloromethane	ND	0.0025	"							
Bromoform	ND	0.0025	"							
Bromomethane	ND	0.0025	"							
n-Butylbenzene	ND	0.0025	"							
sec-Butylbenzene	ND	0.0025	"							
tert-Butylbenzene	ND	0.0025	"							
Carbon tetrachloride	ND	0.0025	"							
Chlorobenzene	ND	0.0025	"							
Chloroethane	ND	0.0025	"							
Chloroform	ND	0.0025	"							
Chloromethane	ND	0.0025	"							
2-Chlorotoluene	ND	0.0025	"							
4-Chlorotoluene	ND	0.0025	"							
Dibromochloromethane	ND	0.0025	"							
1,2-Dibromo-3-chloropropane	ND	0.0050	"							
1,2-Dibromoethane (EDB)	ND	0.0025	"							
Dibromomethane	ND	0.0025	"							
1,2-Dichlorobenzene	ND	0.0025	"							
1,3-Dichlorobenzene	ND	0.0025	"							
1,4-Dichlorobenzene	ND	0.0025	"							
Dichlorodifluoromethane	ND	0.0025	"							
1,1-Dichloroethane	ND	0.0025	"							
1,2-Dichloroethane	ND	0.0025	"							
1,1-Dichloroethene	ND	0.0025	"							
cis-1,2-Dichloroethene	ND	0.0025	"							
trans-1,2-Dichloroethene	ND	0.0025	"							
1,2-Dichloropropane	ND	0.0025	"							
1,3-Dichloropropane	ND	0.0025	"							
2,2-Dichloropropane	ND	0.0025	"							
1,1-Dichloropropene	ND	0.0025	"							
cis-1,3-Dichloropropene	ND	0.0025	"							
trans-1,3-Dichloropropene	ND	0.0025	"							
Hexachlorobutadiene	ND	0.0025	"							
Isopropylbenzene	ND	0.0025	"							

SunStar Laboratories, Inc.

*The results in this report apply to the samples analyzed in accordance with the chain of custody document. This analytical report must be reproduced in its entirety.*

Jeff Lee, Project Manager



25712 Commercentre Drive  
 Lake Forest, California 92630  
 949.297.5020 Phone  
 949.297.5027 Fax

Terracon - Colton  
 1355 East Cooley Dr.  
 Colton CA, 92324

Project: WPT Property Fontana  
 Project Number: CB207103A  
 Project Manager: Todd McFarland

Reported:  
 10/12/20 18:08

**Volatile Organic Compounds by EPA Method 8260B - Quality Control**

**SunStar Laboratories, Inc.**

Analyte	Result	Reporting Limit	Units	Spike Level	Source Result	%REC	%REC Limits	RPD	RPD Limit	Notes
---------	--------	-----------------	-------	-------------	---------------	------	-------------	-----	-----------	-------

**Batch 0100931 - EPA 5030 GCMS**

**Blank (0100931-BLK1)**

Prepared & Analyzed: 10/09/20

**AO-1**

p-Isopropyltoluene	ND	0.0025	mg/kg							
Methylene chloride	ND	0.010	"							
Naphthalene	ND	0.0025	"							
n-Propylbenzene	ND	0.0025	"							
Styrene	ND	0.0025	"							
1,1,2,2-Tetrachloroethane	ND	0.0025	"							
1,1,1,2-Tetrachloroethane	ND	0.0025	"							
Tetrachloroethene	ND	0.0025	"							
1,2,3-Trichlorobenzene	ND	0.0025	"							
1,2,4-Trichlorobenzene	ND	0.0025	"							
1,1,2-Trichloroethane	ND	0.0025	"							
1,1,1-Trichloroethane	ND	0.0025	"							
Trichloroethene	ND	0.0025	"							
Trichlorofluoromethane	ND	0.0025	"							
1,2,3-Trichloropropane	ND	0.0025	"							
1,3,5-Trimethylbenzene	ND	0.0025	"							
1,2,4-Trimethylbenzene	ND	0.0025	"							
Vinyl chloride	ND	0.0025	"							
Benzene	ND	0.0025	"							
Toluene	ND	0.0025	"							
Ethylbenzene	ND	0.0025	"							
m,p-Xylene	ND	0.0050	"							
o-Xylene	ND	0.0025	"							
<i>Surrogate: 4-Bromofluorobenzene</i>	0.0484		"	0.0500		96.9	75.4-139			
<i>Surrogate: Dibromofluoromethane</i>	0.0435		"	0.0500		87.0	73.1-125			
<i>Surrogate: Toluene-d8</i>	0.0477		"	0.0500		95.4	82.6-117			

**LCS (0100931-BS1)**

Prepared & Analyzed: 10/09/20

Chlorobenzene	0.0537	0.0025	mg/kg	0.0500		107	65.2-124			
1,1-Dichloroethene	0.0476	0.0025	"	0.0500		95.1	60.9-131			
Trichloroethene	0.0547	0.0025	"	0.0500		109	62.1-126			
Benzene	0.0501	0.0025	"	0.0500		100	65.3-127			
Toluene	0.0490	0.0025	"	0.0500		98.0	64.3-122			
<i>Surrogate: 4-Bromofluorobenzene</i>	0.0488		"	0.0500		97.7	75.4-139			
<i>Surrogate: Dibromofluoromethane</i>	0.0457		"	0.0500		91.3	73.1-125			
<i>Surrogate: Toluene-d8</i>	0.0492		"	0.0500		98.4	82.6-117			

SunStar Laboratories, Inc.

*The results in this report apply to the samples analyzed in accordance with the chain of custody document. This analytical report must be reproduced in its entirety.*

Jeff Lee, Project Manager

Terracon - Colton  
1355 East Cooley Dr.  
Colton CA, 92324

Project: WPT Property Fontana  
Project Number: CB207103A  
Project Manager: Todd McFarland

Reported:  
10/12/20 18:08

**Volatile Organic Compounds by EPA Method 8260B - Quality Control**

**SunStar Laboratories, Inc.**

Analyte	Result	Reporting Limit	Units	Spike Level	Source Result	%REC	%REC Limits	RPD	RPD Limit	Notes
---------	--------	-----------------	-------	-------------	---------------	------	-------------	-----	-----------	-------

**Batch 0100931 - EPA 5030 GCMS**

**Matrix Spike (0100931-MS1)**

Source: T203529-01

Prepared & Analyzed: 10/09/20

Chlorobenzene	0.0467	0.0025	mg/kg	0.0497	ND	93.9	65.2-125			
1,1-Dichloroethene	0.0435	0.0025	"	0.0497	ND	87.5	60.9-131			
Trichloroethene	0.0489	0.0025	"	0.0497	ND	98.4	62.1-126			
Benzene	0.0460	0.0025	"	0.0497	ND	92.6	65.3-127			
Toluene	0.0429	0.0025	"	0.0497	ND	86.3	64.3-125			
Surrogate: 4-Bromofluorobenzene	0.0480		"	0.0497		96.6	75.4-139			
Surrogate: Dibromofluoromethane	0.0464		"	0.0497		93.3	73.1-125			
Surrogate: Toluene-d8	0.0485		"	0.0497		97.6	82.6-117			

**Matrix Spike Dup (0100931-MSD1)**

Source: T203529-01

Prepared & Analyzed: 10/09/20

Chlorobenzene	0.0453	0.0025	mg/kg	0.0490	ND	92.3	65.2-125	3.04	20	
1,1-Dichloroethene	0.0416	0.0025	"	0.0490	ND	84.8	60.9-131	4.54	20	
Trichloroethene	0.0480	0.0025	"	0.0490	ND	97.9	62.1-126	1.89	20	
Benzene	0.0443	0.0025	"	0.0490	ND	90.5	65.3-127	3.76	20	
Toluene	0.0416	0.0025	"	0.0490	ND	84.9	64.3-125	3.04	20	
Surrogate: 4-Bromofluorobenzene	0.0477		"	0.0490		97.4	75.4-139			
Surrogate: Dibromofluoromethane	0.0458		"	0.0490		93.4	73.1-125			
Surrogate: Toluene-d8	0.0479		"	0.0490		97.8	82.6-117			

SunStar Laboratories, Inc.



Jeff Lee, Project Manager

The results in this report apply to the samples analyzed in accordance with the chain of custody document. This analytical report must be reproduced in its entirety.

Terracon - Colton  
1355 East Cooley Dr.  
Colton CA, 92324

Project: WPT Property Fontana  
Project Number: CB207103A  
Project Manager: Todd McFarland

Reported:  
10/12/20 18:08

### Notes and Definitions

QM-05 The spike recovery was outside acceptance limits for the MS and/or MSD due to possible matrix interference. The LCS was within acceptance criteria. The data is acceptable as no negative impact on data is expected.

AO-1 Internal standards failed low in method blank due to a bad purge. No analyte detection found, therefore no negative impact on samples suspected.

DET Analyte DETECTED

ND Analyte NOT DETECTED at or above the reporting limit

NR Not Reported

dry Sample results reported on a dry weight basis

RPD Relative Percent Difference

---

SunStar Laboratories, Inc.



*The results in this report apply to the samples analyzed in accordance with the chain of custody document. This analytical report must be reproduced in its entirety.*

---

Jeff Lee, Project Manager

# Terracon

Consulting Engineers & Scientists

12035530

Laboratory Address: San Jose Labs  
Lake Forest CA

Office Location: Colton Phone: Office  
 Project Manager: Todd McFarland Contact: Office  
 PO/SO #

## CHAIN OF CUSTODY RECORD

ANALYSIS REQUESTED

VOCs EPA Method 8260  
 TPH EPA method 8015  
 CAM 17 Metals 6010/7471

LAB USE ONLY  
 DUE DATE:

TEMP OF COOLER WHEN RECEIVED (°C)  
5.6

Page 1 of 2

Sampler's Name: ESBY Sampler's Signature: [Signature]

Project Number: CR320703A Project Name: WRP Property Fontana

Matrix	Date	Time	Comp	Grab	Identifying Marks of Sample(s)	Start Depth	End Depth	No. Type of Containers		TRRP Laboratory Review Checklist	NOTES
								40 ml GBS	Plastic		
5	10/11/08	0913		X	SB-1-5			X	X		
5	"	0915		X	SB-1-8			X	X		
5	"	0930		X	SB-2-5			X	X		
5	"	0935		X	SB-2-10			X	X		
5	"	1000		X	SB-3-5			X	X		
5	"	1035		X	SB-4-5			X	X		
5	"	1102		X	SB-5-5			X	X		
5	"	1118		X	SB-6-3			X	X		
5	"	1124		X	SB-6-5			X	X		
5	"	1225		X	SB-7-5			X	X		

TURNAROUND TIME:  Normal  48-Hour Rush  24-Hour Rush

Relinquished by (Signature): [Signature] Date: 10/8/2010 Time: 14:50  
 Received by (Signature): [Signature] Date: 10-8-20 Time: 14:50

Relinquished by (Signature): [Signature] Date: 10-8-20 Time: 16:30  
 Received by (Signature): [Signature] Date: 10-8-20 Time: 6:50

Relinquished by (Signature): [Signature] Date: 10-8-20 Time: 16:30  
 Received by (Signature): [Signature] Date: 10-8-20 Time: 6:50

Matrix: WW - Wastewater W - Water S - Soil L - Liquid A - Air Bag C - Charcoal Tube SL - Sludge O - Oil  
 Container: VOA - 40 ml vial M/G - Amber Glass 1 L 250 ml = Glass wide mouth P/O Plastic or other

California Office ■ 1355 E. Cooley Drive, Suite C ■ Colton, CA 92324 ■ (909) 824-7311

Responsive ■ Resourceful ■ Reliable





## SAMPLE RECEIVING REVIEW SHEET

Batch/Work Order #: T203530

Client Name: \_\_\_\_\_ Project: WPT Property Fontana

Delivered by:  Client  SunStar Courier  GLS  FedEx  Other

If Courier, Received by: Dave Date/Time Courier Received: 10-8-20

Lab Received by: Dan Date/Time Lab Received: 10-8-20

Total number of coolers received: 1 Thermometer ID: SC-1 Calibration due: 8/17/21

Temperature: Cooler #1	<u>5.8</u>	°C +/- the CF (-0.2°C) =	<u>5.6</u>	°C corrected temperature
Temperature: Cooler #2		°C +/- the CF (-0.2°C) =		°C corrected temperature
Temperature: Cooler #3		°C +/- the CF (-0.2°C) =		°C corrected temperature
<b>Temperature criteria = ≤ 6°C (no frozen containers)</b>		Within criteria?		<input checked="" type="checkbox"/> Yes <input type="checkbox"/> No
<b>If NO:</b>				
Samples received on ice?		<input type="checkbox"/> Yes	<input type="checkbox"/> No →	<b>Complete Non-Conformance Sheet</b>
If on ice, samples received same day collected?		<input type="checkbox"/> Yes → Acceptable	<input type="checkbox"/> No →	<b>Complete Non-Conformance Sheet</b>

Custody seals intact on cooler/sample  Yes  No\*  N/A

Sample containers intact  Yes  No\*

Sample labels match Chain of Custody IDs  Yes  No\*

Total number of containers received match COC  Yes  No\*

Proper containers received for analyses requested on COC  Yes  No\*

Proper preservative indicated on COC/containers for analyses requested  Yes  No\*  N/A

Complete shipment received in good condition with correct temperatures, containers, labels, volumes preservatives and within method specified holding times  Yes  No\*

\* Complete Non-Conformance Receiving Sheet if checked

Cooler/Sample Review - Initials and date: DB 10-8-20

**Comments:**

---

**T203530**

**SunStar Laboratories, Inc.**

**Client:** Terracon - Colton  
**Project:** WPT Property Fontana

**Project Manager:** Jeff Lee  
**Project Number:** CB207103A

**Report To:**

Terracon - Colton  
 Todd McFarland  
 1355 East Cooley Dr.  
 Colton, CA 92324  
 Phone: (909) 824-7311  
 Fax: -

**Invoice To:**

Terracon - Colton  
 Todd McFarland  
 1355 East Cooley Dr.  
 Colton, CA 92324  
 Phone : (909) 824-7311  
 Fax: -

Date Due: 10/12/20 17:00 (1 day TAT)

Received By: Dan Marteski

Date Received: 10/08/20 16:30

Logged In By: Dave Berner

Date Logged In: 10/08/20 18:21

Samples Received at: **5.6°C**  
 Custody Seals No Received On Ice Yes  
 Containers Intact Yes  
 COC/Labels Agree Yes  
 Preservation Confir No

Analysis	Due	TAT	Expires	Comments
<b>T203530-01 SB-1-5 [Soil] Sampled 10/07/20 09:13 (GMT-08:00) Pacific Time (US &amp; [NO ANALYSES]</b>				<b>HOLD</b>
<b>T203530-02 SB-1-8 [Soil] Sampled 10/07/20 09:15 (GMT-08:00) Pacific Time (US &amp;</b>				
8260	10/12/20 15:00	1	10/21/20 09:15	
8015 Carbon Chain	10/12/20 15:00	1	10/21/20 09:15	
<b>T203530-03 SB-2-5 [Soil] Sampled 10/07/20 09:13 (GMT-08:00) Pacific Time (US &amp; [NO ANALYSES]</b>				<b>HOLD</b>
<b>T203530-04 SB-2-10 [Soil] Sampled 10/07/20 09:35 (GMT-08:00) Pacific Time (US &amp;</b>				
8260	10/12/20 15:00	1	10/21/20 09:35	
8015 Carbon Chain	10/12/20 15:00	1	10/21/20 09:35	
6010 Title 22	10/12/20 15:00	1	04/05/21 09:35	
<b>T203530-05 SB-3-5 [Soil] Sampled 10/07/20 10:00 (GMT-08:00) Pacific Time (US &amp;</b>				
8260	10/12/20 15:00	1	10/21/20 10:00	
8015 Carbon Chain	10/12/20 15:00	1	10/21/20 10:00	

**T203530**

**SunStar Laboratories, Inc.**

<b>Client:</b> Terracon - Colton	<b>Project Manager:</b> Jeff Lee
<b>Project:</b> WPT Property Fontana	<b>Project Number:</b> CB207103A

Analysis	Due	TAT	Expires	Comments
<b>T203530-06 SB-4-5 [Soil] Sampled 10/07/20 10:35 (GMT-08:00) Pacific Time (US &amp;</b>				
8260	10/12/20 15:00	1	10/21/20 10:35	
8015 Carbon Chain	10/12/20 15:00	1	10/21/20 10:35	
<b>T203530-07 SB-5-5 [Soil] Sampled 10/07/20 11:02 (GMT-08:00) Pacific Time (US &amp;</b>				
8015 Carbon Chain	10/12/20 15:00	1	10/21/20 11:02	
8260	10/12/20 15:00	1	10/21/20 11:02	
<b>T203530-08 SB-6-3 [Soil] Sampled 10/07/20 11:18 (GMT-08:00) Pacific Time (US &amp;</b>				
8015 Carbon Chain	10/12/20 15:00	1	10/21/20 11:18	
6010 Title 22	10/12/20 15:00	1	04/05/21 11:18	
8260	10/12/20 15:00	1	10/21/20 11:18	
<b>T203530-09 SB-6-5 [Soil] Sampled 10/07/20 11:24 (GMT-08:00) Pacific Time (US &amp;</b>				
8260	10/12/20 15:00	1	10/21/20 11:24	
8015 Carbon Chain	10/12/20 15:00	1	10/21/20 11:24	
<b>T203530-10 SB-7-5 [Soil] Sampled 10/07/20 12:25 (GMT-08:00) Pacific Time (US &amp;</b>				
8260	10/12/20 15:00	1	10/21/20 12:25	
8015 Carbon Chain	10/12/20 15:00	1	10/21/20 12:25	
<b>T203530-11 SB-8-5 [Soil] Sampled 10/07/20 12:40 (GMT-08:00) Pacific Time (US &amp;</b>				
8260	10/12/20 15:00	1	10/21/20 12:40	
8015 Carbon Chain	10/12/20 15:00	1	10/21/20 12:40	
<b>T203530-12 SB-9-5 [Soil] Sampled 10/07/20 12:55 (GMT-08:00) Pacific Time (US &amp;</b>				
8260	10/12/20 15:00	1	10/21/20 12:55	
8015 Carbon Chain	10/12/20 15:00	1	10/21/20 12:55	
<b>T203530-13 SB-10-5 [Soil] Sampled 10/07/20 13:27 (GMT-08:00) Pacific Time (US &amp;</b>				
8015 Carbon Chain	10/12/20 15:00	1	10/21/20 13:27	
8260	10/12/20 15:00	1	10/21/20 13:27	

T203530

SunStar Laboratories, Inc.

Client: Terracon - Colton  
Project: WPT Property Fontana

Project Manager: Jeff Lee  
Project Number: CB207103A

Analysis	Due	TAT	Expires	Comments
<b>T203530-14 SB-11-5 [Soil] Sampled 10/07/20 13:45 (GMT-08:00) Pacific Time (US &amp;</b>				
8015 Carbon Chain	10/12/20 15:00	1	10/21/20 13:45	
8260	10/12/20 15:00	1	10/21/20 13:45	

Analysis groups included in this work order

6010 Title 22

subgroup 6010B T22      7470/71 Hg